

# EK-Quantum Vector3 RTX 5080/90 Thermal Pad Kit

ACCESSORIES

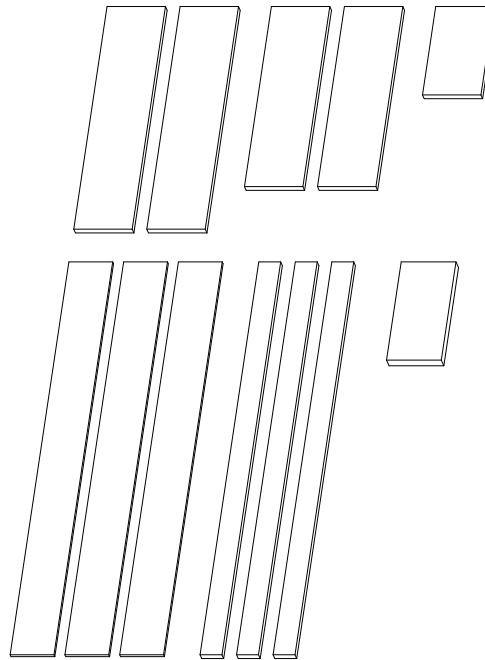

This product is intended for installation only by expert users. Please consult with a qualified technician for installation. Improper installation may result in damage to your equipment. EK Water Blocks assumes no liability whatsoever, expressed or implied, for the use of these products, nor their installation. The following instructions are subject to change without notice. Please visit our website at [www.ekwb.com](http://www.ekwb.com) for updates. Before installation of this product, please read important notice, disclosure, and warranty conditions that are printed on the back of the box.

Before you start using this product, please follow these basic guidelines:

**Please carefully read the manual before beginning the installation process.**

**The EK Fittings require only a small amount of force to screw them firmly in place since the liquid seal is ensured by the rubber O-ring gaskets.**

**The use of corrosion inhibiting coolants is always recommended for liquid cooling systems, and mandatory for nickel plated water blocks.**

**Do not use pure distilled water! For best results EK recommends the use of EK-Cryo Fuel coolants.**

**Make sure to thoroughly bleed air out of your water block, or you will not reach optimal performance.**

## **TABLE OF CONTENTS**

<b>BOX CONTENTS .....</b>	<b>4</b>
<b>TECHNICAL SPECIFICATIONS .....</b>	<b>5</b>
<b>CUTTING AND PLACING THERMAL PADS .....</b>	<b>6</b>
<b>SUPPORT AND SERVICE .....</b>	<b>7</b>

## BOX CONTENTS

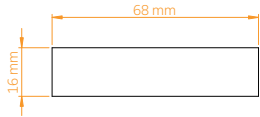

Thermal Pad - VRAM 68x16x2 (2 pcs)

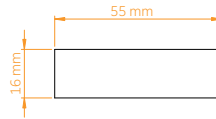

Thermal Pad - VRAM 55x16x2 (2 pc)

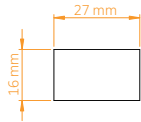

Thermal Pad - VRAM 27x16x2 (1 pc)

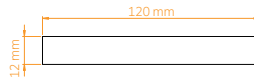

Thermal Pad - Inductor 120x12x1 (3 pcs)

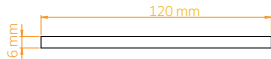

Thermal Pad - VRM 120x6x2 (3 pcs)

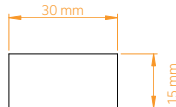

Thermal Pad BP Chip 30x15x3 (1 pc)

# TECHNICAL SPECIFICATIONS

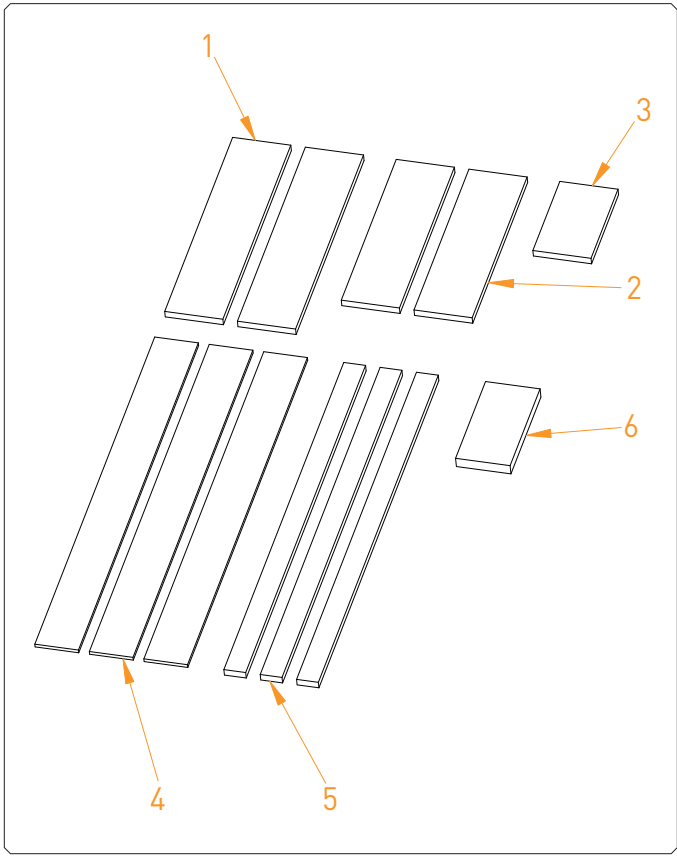

Pos.	EAN	Description	Qty.
1	3831129901582	Thermal Pad - VRAM - 68x16x2	2
2	3831129901575	Thermal Pad - VRAM - 55x16x2	2
3	3831129901599	Thermal Pad - VRAM - 27x16x2	1
4	3831129901551	Thermal Pad - Inductor - 120x12x1	3
5	3831129901568	Thermal Pad - Mosfet - 120x6x2	3
6	3831129901605	Thermal Pad - BP Chip - 30x15x3	1

□

## CUTTING AND PLACING THERMAL PADS

This thermal pad kit is intended as a replacement for the thermal pads supplied with the EK-Quantum Vector<sup>3</sup> 5080/90 water block.

Thermal pad placement, dimensions, and thickness depend on the specific water block model. For correct installation, please refer to the installation manual of your water block.

3831129901179 EK-Quantum Vector<sup>3</sup> FE RTX 5090 - Plexi <https://www.ekwb.com/shop/EK-IM/EK-IM-3831129901179.pdf>

3831129901117 EK-Quantum Vector<sup>3</sup> Astral RTX 5090 - Plexi <https://www.ekwb.com/shop/EK-IM/EK-IM-3831129901117.pdf>

3831129901100 EK-Quantum Vector<sup>3</sup> TUF RTX 5070 Ti/5080 - Plexi <https://www.ekwb.com/shop/EK-IM/EK-IM-3831129901100.pdf>

3831129901094 EK-Quantum Vector<sup>3</sup> TUF RTX 5090 - Plexi <https://www.ekwb.com/shop/EK-IM/EK-IM-3831129901094.pdf>

3831129901124 EK-Quantum Vector<sup>3</sup> Astral RTX 5080 - Plexi <https://www.ekwb.com/shop/EK-IM/EK-IM-3831129901124.pdf>

3831129901155 EK-Quantum Vector<sup>3</sup> Suprim RTX 5090 - Plexi <https://www.ekwb.com/shop/EK-IM/EK-IM-3831129901155.pdf>

3831129901148 EK-Quantum Vector<sup>3</sup> Master RTX 5090 - Plexi <https://www.ekwb.com/shop/EK-IM/EK-IM-3831129901148.pdf>

## SUPPORT AND SERVICE

In case you need assistance or wish to order spare parts or a new mounting mechanism, please contact:

**<https://www.ekwb.com/customer-support/>**

For spare parts orders, refer to the page with "TECHNICAL SPECIFICATIONS AND WATER BLOCK PARTS" where you can find the EAN number of each part you might need.

Include the EAN number with quantity in your request. Mounting Mechanism EAN can be found under "BOX CONTENTS"

Thermal pads are readily available in the EKshop

## SOCIAL MEDIA

 EKbyLMTEK

 @EKbyLMTEK

 ekwaterblocks

 @EKbyLMTEK

 LM TEK (The Home of EK)

