

# EK-Loop

## Vertical GPU Holder EVO - Gen4 Riser (shifted)

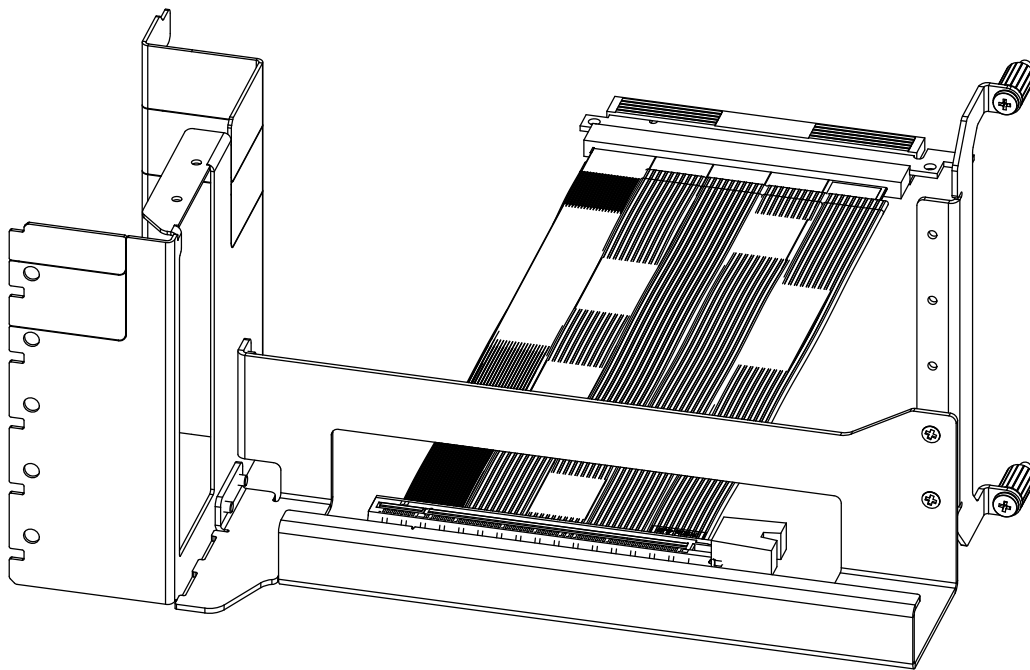

Please note the installation of the product is intended to be undertaken by an adequately trained and experienced person. You are installing the product at your own risk. If you are not properly trained or experienced or feel unsure about the installation procedure, please refrain from installing the product yourself and contact our tech support for assistance. We disclaim our liability for any damages to the product as well as incidental, consequential, or indirect damages incurred due to improper or inappropriate installation.

**Carefully read the manual before beginning with the installation process!**

## **SAFETY PRECAUTIONS**

1. Keep and store the product away from the reach of children.
2. Check the component list and condition of the product before installation. In case you encounter a problem, contact the shop where you have purchased the product to get a replacement or a refund.
3. Before installation of the Vertical GPU Holder, power off your computer and unplug the power cables.
4. EK is not responsible for any damages due to external causes, including but not limited to: improper use, problems with electrical power, accident, neglect, alteration, repair, improper installation, and improper testing.
5. CPU, GPU, and motherboard are subject to damage if the product is incorrectly installed.
6. Product design and specifications may be revised to improve quality and performance.



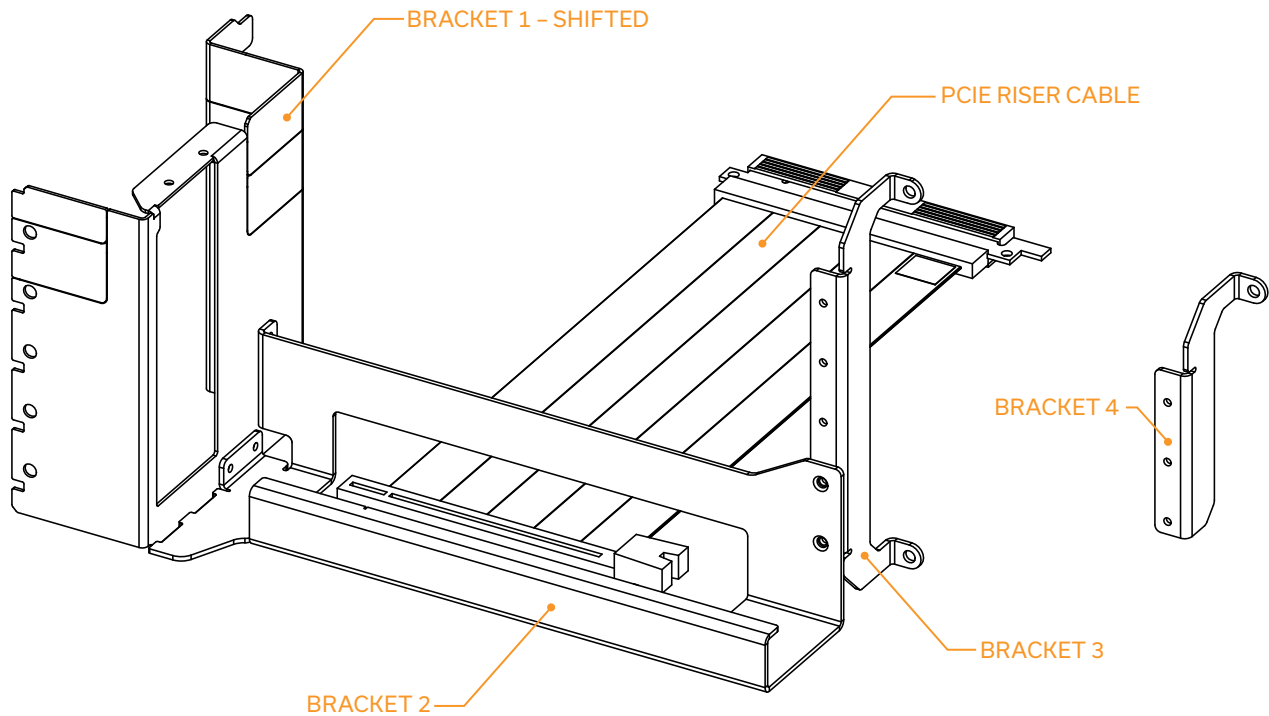

## TABLE OF CONTENTS

WHAT IS ENCLOSED .....	4
REQUIRED TOOLS .....	5
DIMENSIONS OF THE VERTICAL GPU HOLDER .....	6
INSTALLATION GUIDE .....	7
SUPPORT AND SERVICE .....	13
SOCIAL MEDIA .....	13

## WHAT IS ENCLOSED

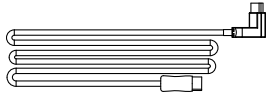
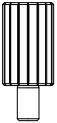

**Mounting mechanism:** You may not need all the screws from the package! EAN: 104785

			
M3x5 Countersunk Screw (7x)	Protective Foam 2mm (2x)	Screw M2.5x4 DIN7985 (3x)	UNC 6/32x1/4-Phillips Pan Screw ( 7x)
			
Standoff-UNC6-32x13x5 (2x)	DP Cable (1x)	Standoff M3-32x13x5 (2x)	

## REQUIRED TOOLS

Phillips Head Screwdriver

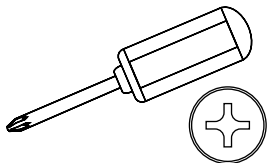

## DIMENSIONS OF THE VERTICAL GPU HOLDER

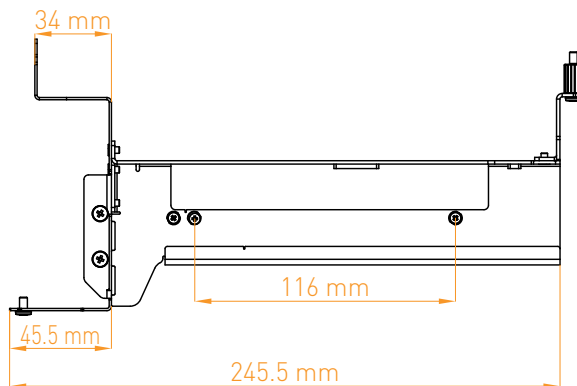
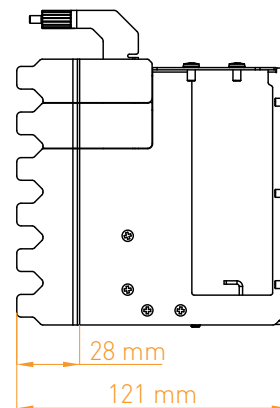
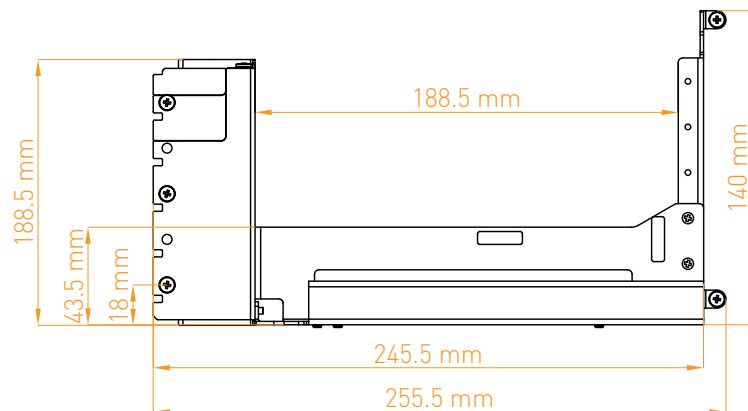

## INSTALLATION GUIDE

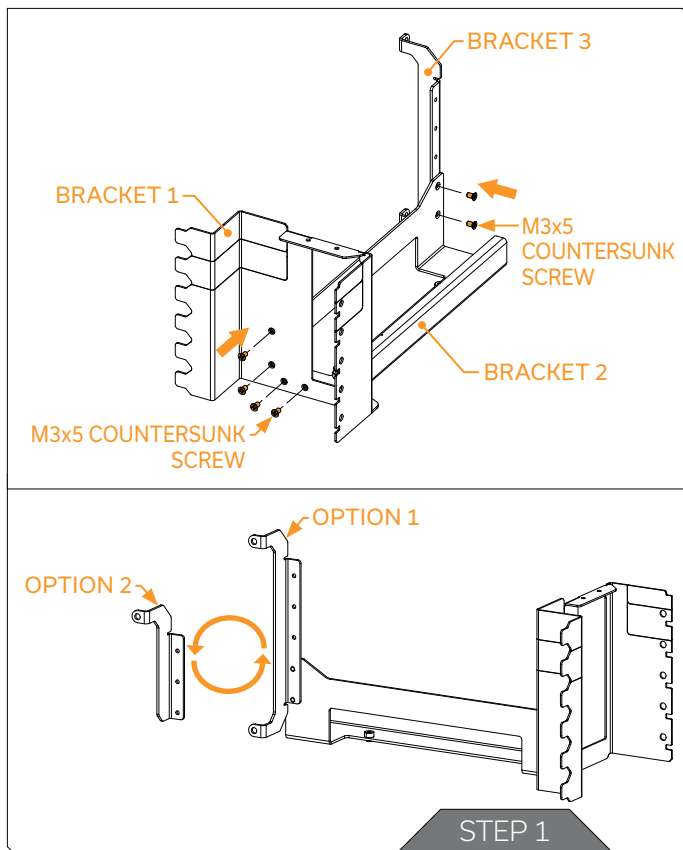

### STEP 1

Assemble the three steel brackets with the six M3x5 countersunk screws. Depending on how you want to position the GPU holder inside your PC, you may choose between two options.



In some cases, you may skip the installation of the »Bracket 3« if it interferes with other components inside your PC. You should check this before proceeding with the installation. In most cases, the assembly of »Bracket 1« and »Bracket 2« should provide sufficient load-bearing capacity, while the »Bracket 3« will provide additional stiffness and stability for the whole GPU Holder.

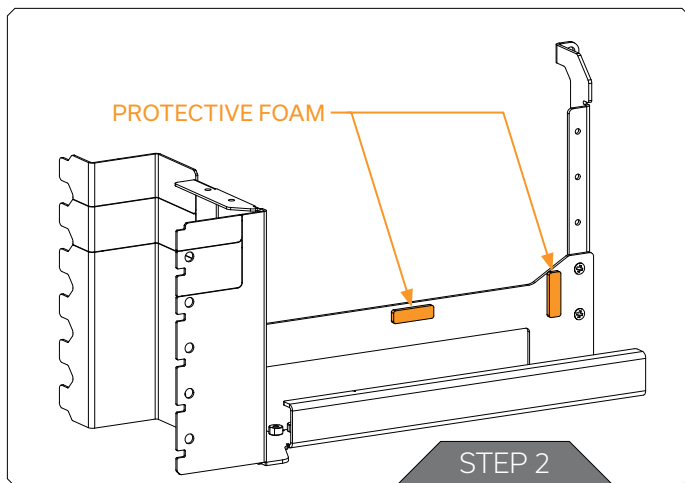

## STEP 2

Stick two (2) protective adhesive foams, as indicated in the diagram.

The »2 mm protective foam« should be enough for the protection of your GPU during installation.

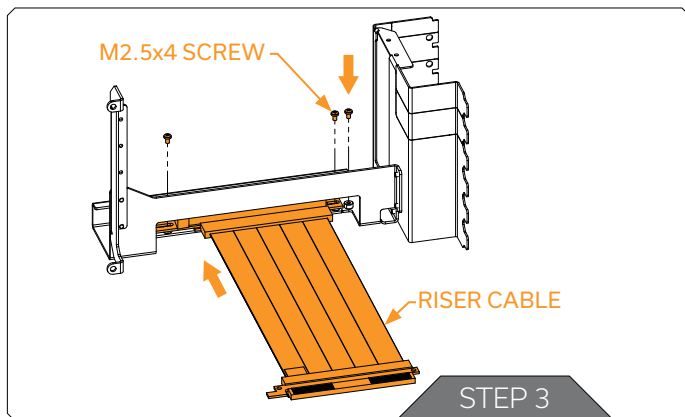

## STEP 3

Attach the PCIe riser cable to the bracket's assembly with three (3) M2.5 x 4 Phillips pan head screws.



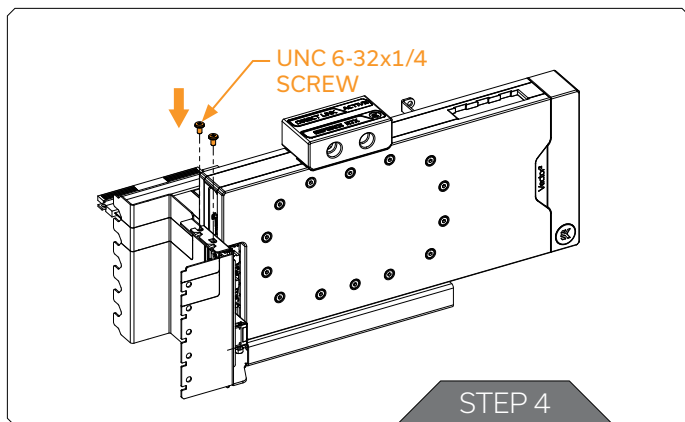

#### STEP 4



Before you mount the GPU, make sure the PCIe latch is not closed – it must be pushed to the right side.

Carefully mount the GPU onto the GPU Holder, using two (2) UNC 6-32x1/4 screws. Pay special attention not to damage the GPU.



Secure the GPU by moving the PCIe latch that is positioned underneath it, to the left. You may use a credit card, screwdriver, or similar item to move the latch.

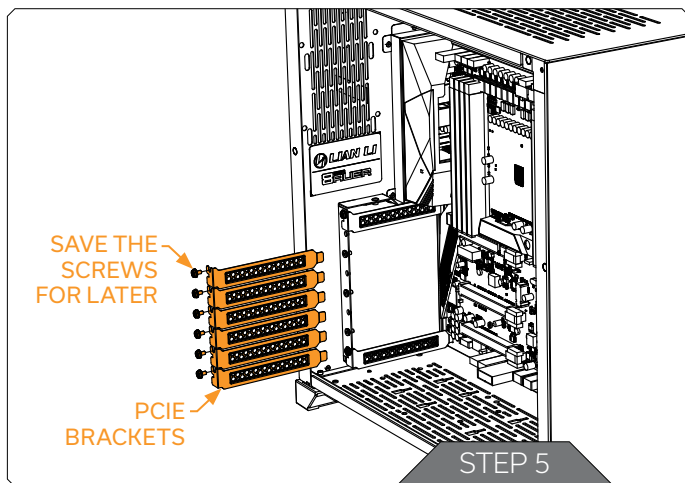

#### STEP 5



Before you start to assemble the Holder with the GPU to the motherboard, make sure that your computer is powered off and the PSU power cable unplugged. It is also recommended that you put your computer with the motherboard in a horizontal position before you continue with the installation process.

Remove the six appropriate PCIe brackets from your case. Which brackets you need to remove depends on the installation option you chose at STEP 1.

Save all removed screws - you'll need them later.

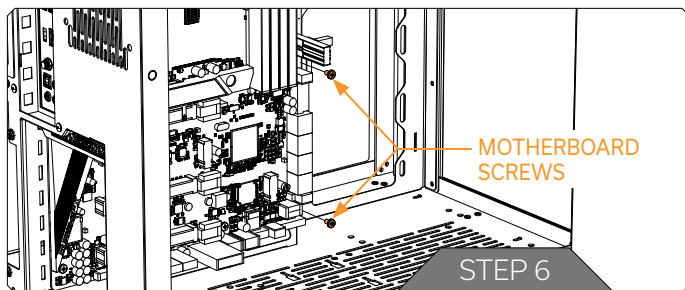

### STEP 6

Remove the two screws at the bottom right side of the motherboard. Save the screws for later use.

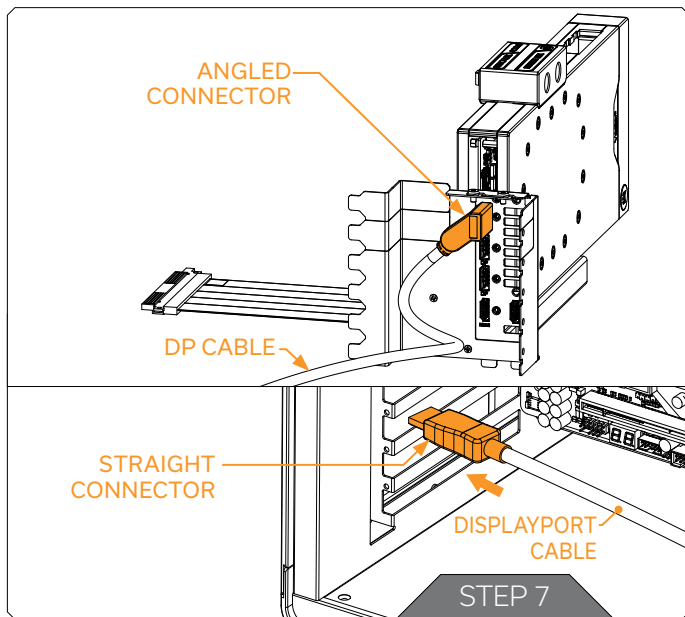

### STEP 7

Before you mount the GPU Holder in your PC, connect the angled connector of the enclosed DisplayPort cable to the GPU, then pull the cable's straight connector through the horizontal bars (where you previously removed the PCIe brackets).

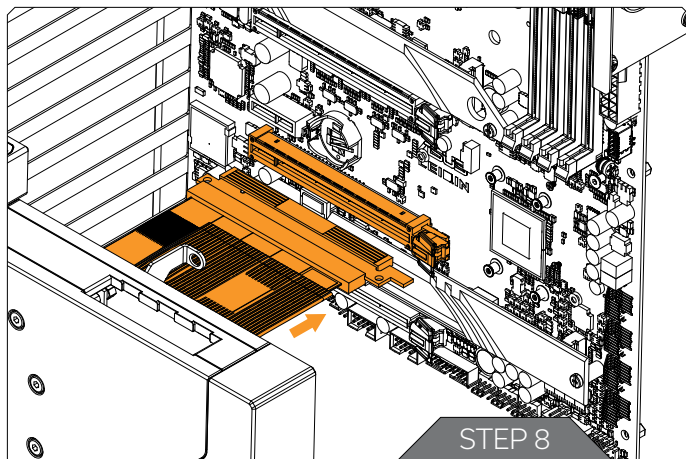

## STEP 8



During the following Steps of the installation process, be especially careful not to hit or scratch your motherboard or any other PC component while you're mounting the GPU Holder to the motherboard. Pay special attention that the »Bracket 3« of the GPU Holder (the right side) doesn't hit the motherboard.

Carefully connect the Riser cable from the GPU Holder to the PCIe slot on the motherboard.

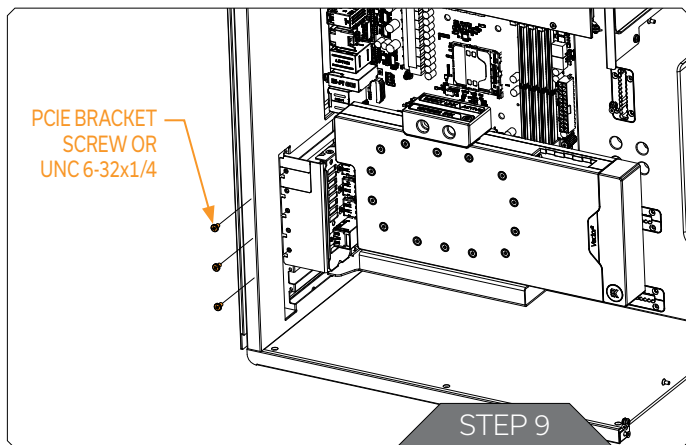

## STEP 9

Use three or more screws to attach the GPU Holder to the left side of the PC case.

Use the PCIe bracket screws that you've saved earlier or UNC 6-32x1/4 screws from the package.

If using the GPU Holder on the upper positions of the PC case, you may have to break off one (1) or two (2) of the PCIe Brackets on the holder.

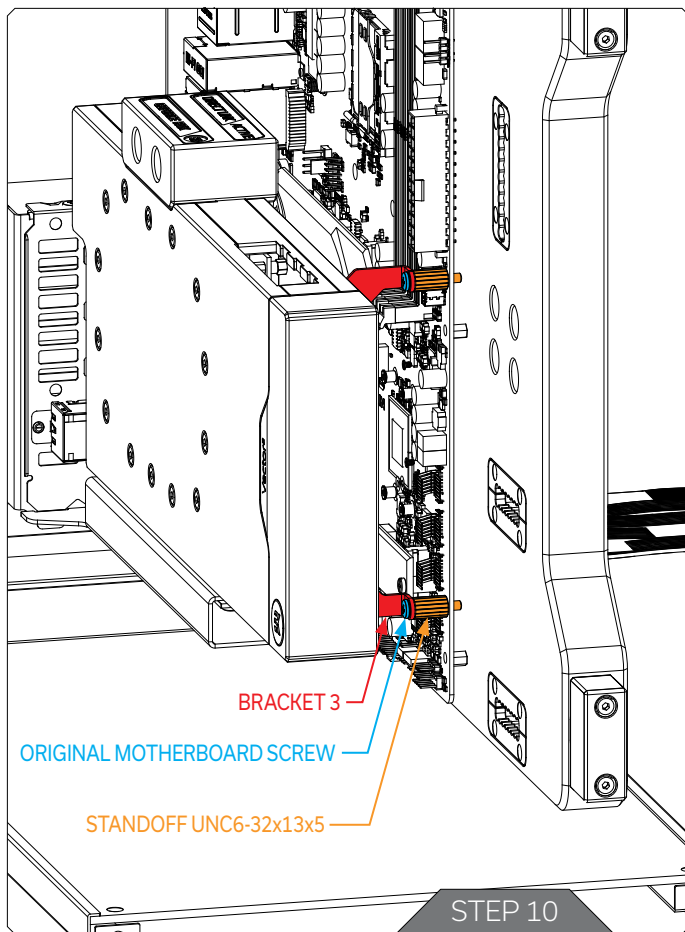

### STEP 10

Place two (2) Standoffs UNC6-32x13x5 under the "Bracket 3" and secure them on the motherboard.

Use the saved motherboard screws (from STEP 6) or mounting screws to secure the right side of the GPU Holder to the PC case.

### STEP 11

Finally, connect the GPU cables (as instructed by the GPU manufacturer) to complete the installation.

## SUPPORT AND SERVICE

In case you need assistance, please contact:

**<http://support.ekwb.com/>**

EKWB d.o.o.  
Pod lipami 18  
1218 Komenda  
Slovenia - EU

## SOCIAL MEDIA

 EKWaterBlocks

 @EKWaterBlocks

 ekwaterblocks

 EKWBofficial

 ekwaterblocks

