

EK-Loop Vertical GPU Holder EV0 - Gen4 Riser

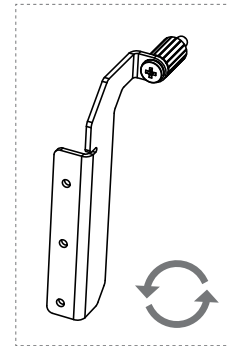
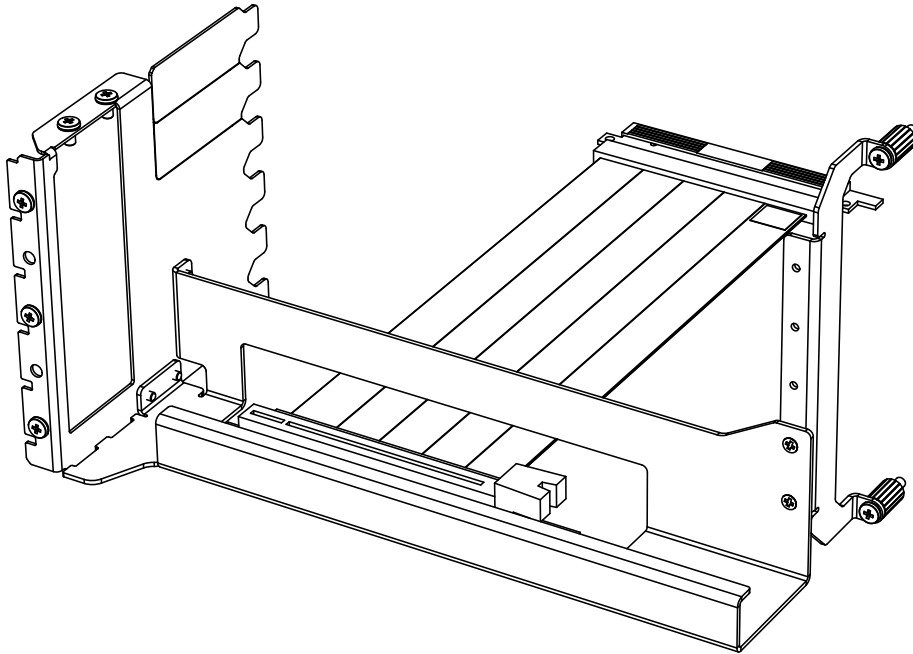

This product is intended for installation by expert users only. Please consult with a qualified technician since improper installation may result in damage to the equipment. EK assumes no liability whatsoever, expressed or implied, for the use of this product, nor its installation. The following instructions are subject to change without notice. Please visit our website at www.ekwb.com for updates.

Carefully read the manual before beginning with the installation process!

SAFETY PRECAUTIONS

1. Keep and store the product away from the reach of children.
2. Check the component list and condition of the product before installation. In case you encounter a problem, contact the shop where you have purchased the product to get a replacement or a refund.
3. Before installation of the Vertical GPU Holder, power off your computer and unplug the power cables.
4. EK is not responsible for any damages due to external causes, including but not limited to: improper use, problems with electrical power, accident, neglect, alteration, repair, improper installation, and improper testing.
5. CPU, GPU, and motherboard are subject to damage if the product is incorrectly installed.
6. Product design and specifications may be revised to improve quality and performance.

TABLE OF CONTENTS

WHAT IS ENCLOSED	4
REQUIRED TOOLS	5
DIMENSIONS OF THE VERTICAL GPU HOLDER	6
INSTALLATION GUIDE	7
SUPPORT AND SERVICE	16
SOCIAL MEDIA	16

WHAT IS ENCLOSED

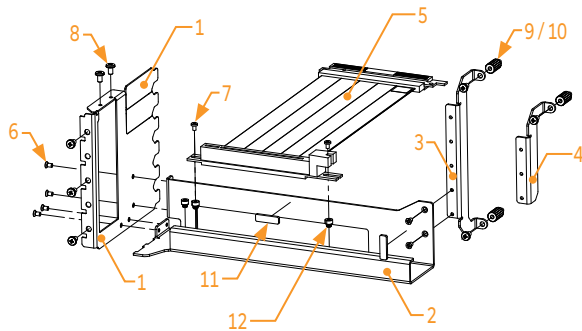





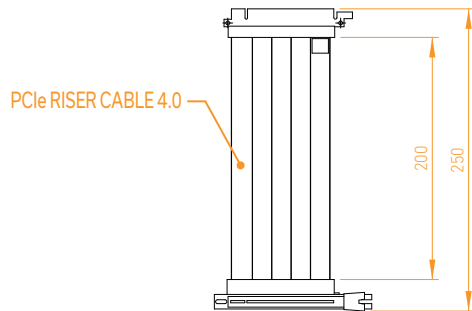

Position	EAN	Description	Quantity
1	104623	Bracket 1	1
2	104625	Bracket 2	1
3	104627	Bracket 3	1
4	104744	Bracket 4	1
5	103483	PCIe Riser Cable 4.0	1

6	102789	M3x5 Countersunk Screw	6
7	8107	M2.5x4 DIN7985 Screw	2
8	102689	UNC 6-32x1/4" Screw	7
9	104921	UNC 6-32x1/4" Standoff Spacer	2
10	104920	M3 Standoff Spacer	2
11	102536	Protective foam	2
12	8972	M4/M2.5x3.3 x3.3 STANDOFF	3

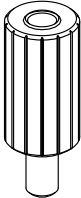
Universal Mounting Mechanism

EAN: 104785



 <p>M3 Standoff Spacer (2x)</p>	 <p>UNC 6-32 Standoff Spacer (2x)</p>	 <p>UNC 6-32x1/4" (7x)</p>	 <p>M2.5x4 Phillips Pan Head Screw (3x)</p>
 <p>M3x5 Countersunk Screw (6x)</p>	 <p>Protective Foam 2mm (2x)</p>	<p>Universal Mounting Mechanism – You may not need every screw from this package. EAN: 104785</p>	

REQUIRED TOOLS



DIMENSIONS OF THE VERTICAL GPU HOLDER

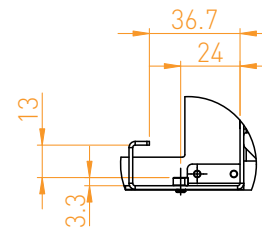
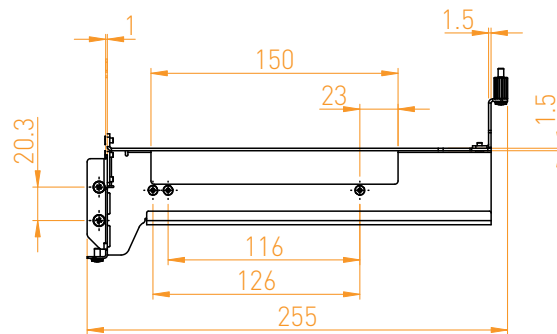
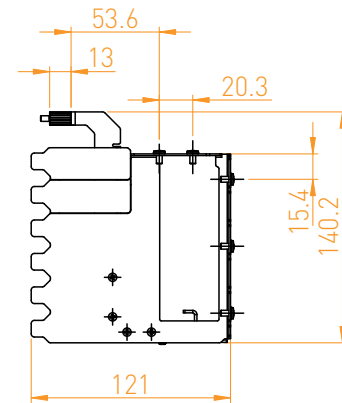
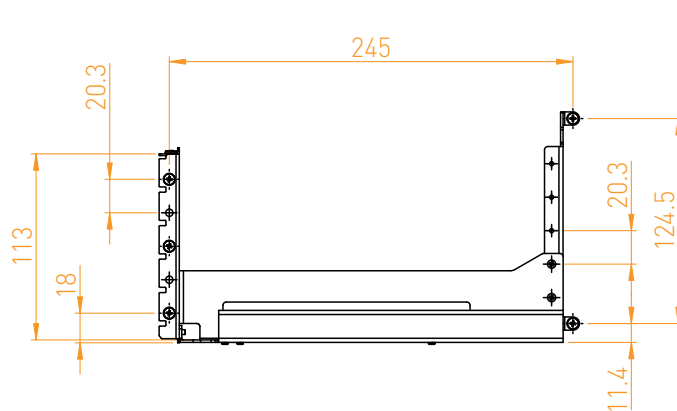

INSTALLATION GUIDE

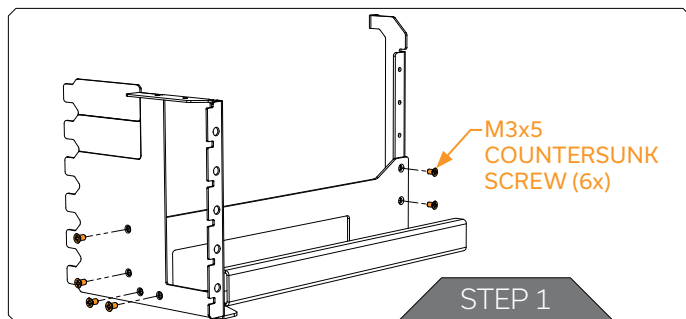

STEP 1



Before you start to assemble the Holder with the GPU to the motherboard, make sure that your computer is powered off and the PSU power cable unplugged. It is also recommended that you put your computer with the motherboard in a horizontal position before you continue with the installation process.

Assemble the three steel brackets with the six M3x5 countersunk screws. Depending on how you want to position the GPU holder inside your PC, you may choose between different options and Bracket 3 or Bracket 4:

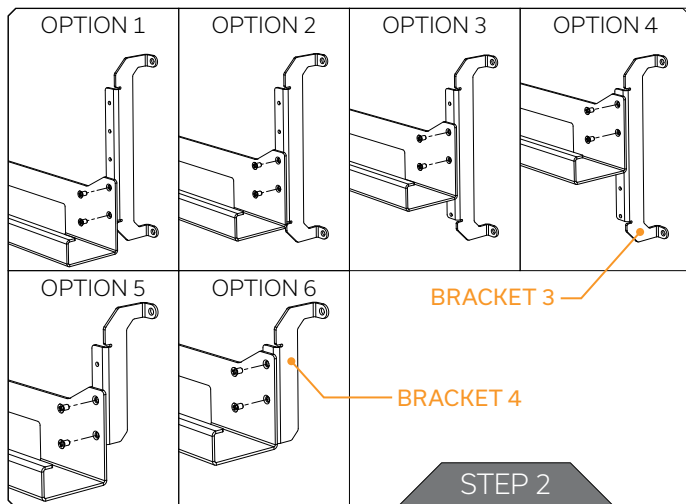

STEP 2

Plan how you will mount the GPU holder in the PC case. There are several options:

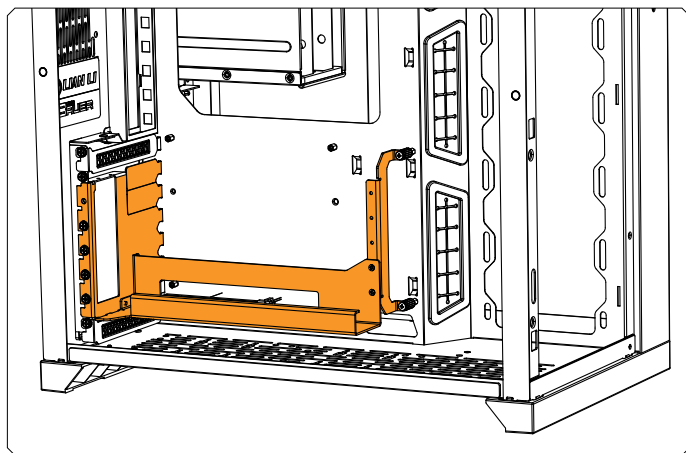

OPTION 1

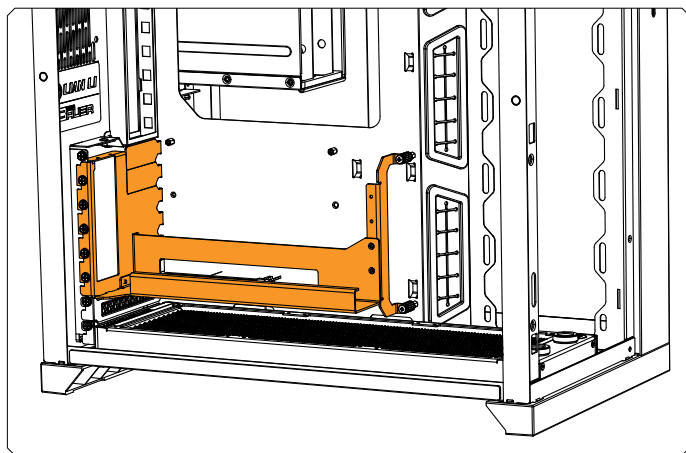

OPTION 2

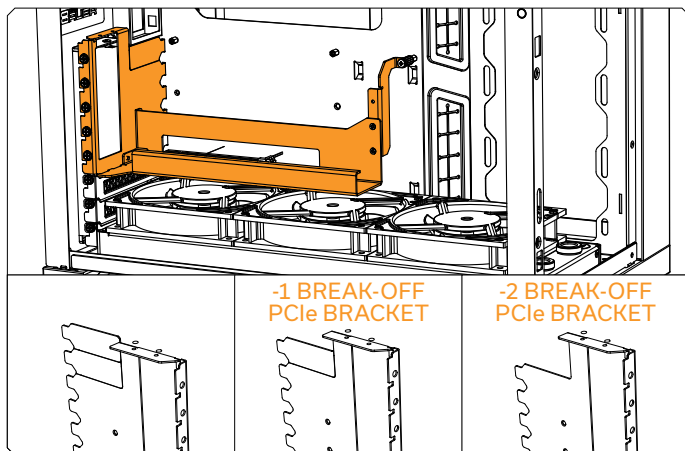

OPTION 5

In this position, the GPU Holder may support 3-slot GPUs because the GPU clamping part of the Holder is raised above the PCIe bracket holder part of PC chassis. You still need to double check that there will be no overlapping of I / O ports or interference of the GPU with the CPU cooler.

If using the GPU Holder on the upper positions of the PC case, you may have to break off 1 or 2 of the PCIe Brackets on the holder.

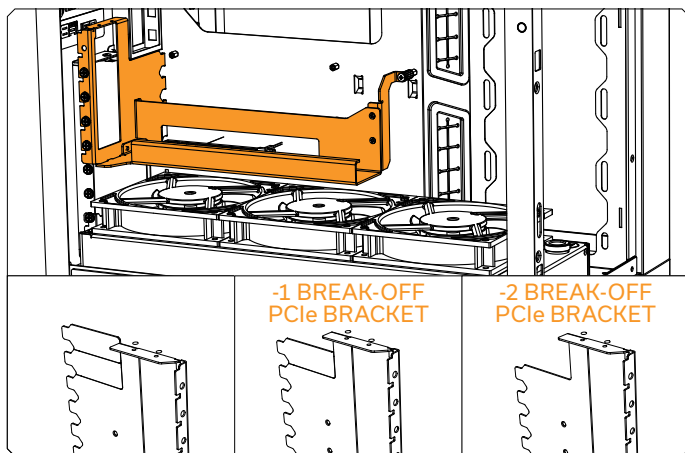

OPTION 6

In this position, the GPU Holder may support 3-slot GPUs because the GPU clamping part of the Holder is raised above the PCIe bracket holder part of PC chassis. You still need to double check that there will be no overlapping of I / O ports or interference of the GPU with the CPU cooler.

If using the GPU Holder on the upper positions of the PC case, you may have to break off 1 or 2 of the PCIe Brackets on the holder.

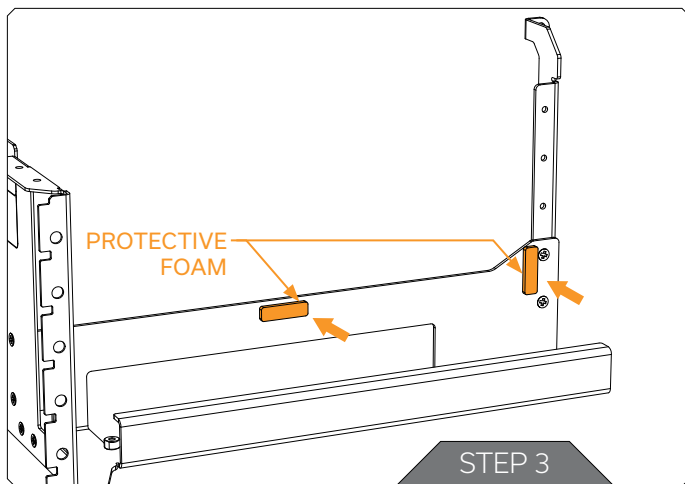

STEP 3

Before mounting the GPU on a holder, you may stick 1 or 2 protective adhesive foams for the extra protection of your GPU during installation.

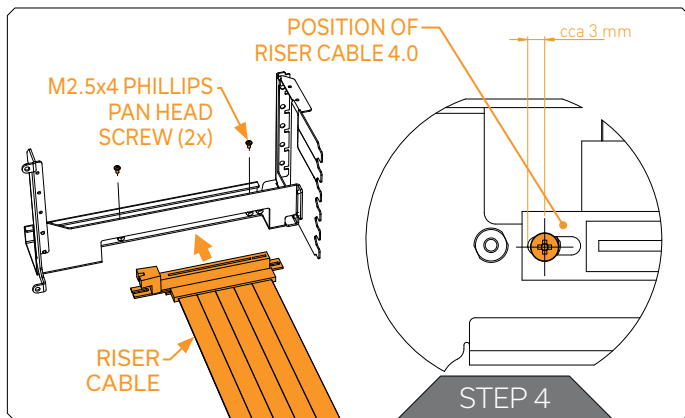

STEP 4

Attach the PCIe Riser Cable 4.0 on a holder with two M2.5x4 Phillips pan head screws. Be sure that the cable is positioned on the holder as is shown in the scheme.

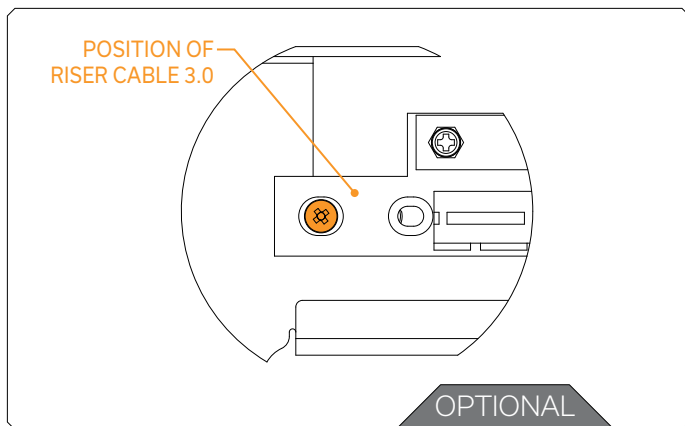

OPTIONAL STEP

This GPU Holder is also compatible with the previous 3.0 version of the EK Riser cable. When mounting 3.0 cable position it differently, as is shown in the scheme. Attach it with two M2.5x4 Phillips pan head screws.

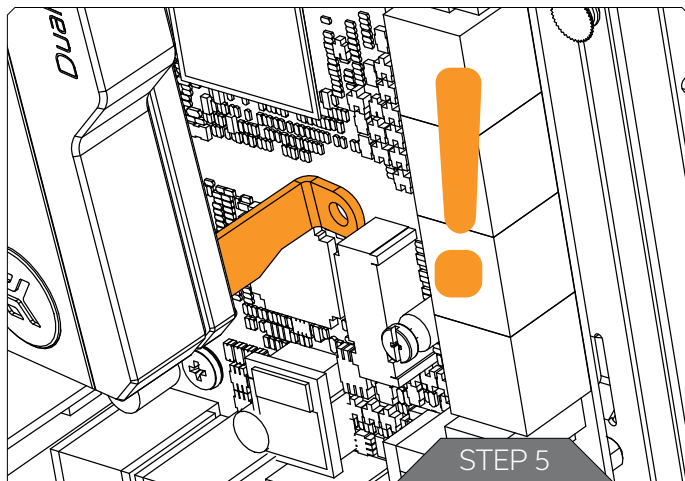

STEP 5



During the following Steps of the installation process, be especially careful not to hit or scratch your motherboard or any other PC component while you're mounting the GPU Holder to the motherboard. Pay special attention that the »Bracket 3« of the GPU Holder (the right side) doesn't hit the motherboard.

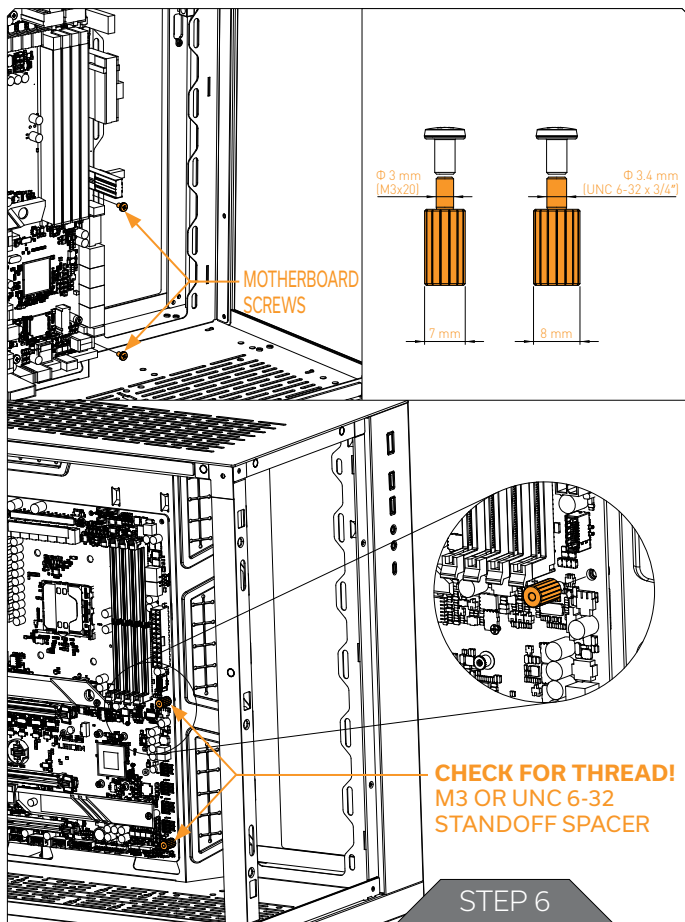

STEP 6

Remove the two screws from the bottom right side of the motherboard (or just the one in the middle if you will use Bracket 4 instead of Bracket 3).

Compare one of the removed screws with both of the Standoff spacers from the package to determine which has the same thread (M3 or UNC 6-32).

Attach the correct Standoff spacer (or two spacers) through the motherboard to the PC case.

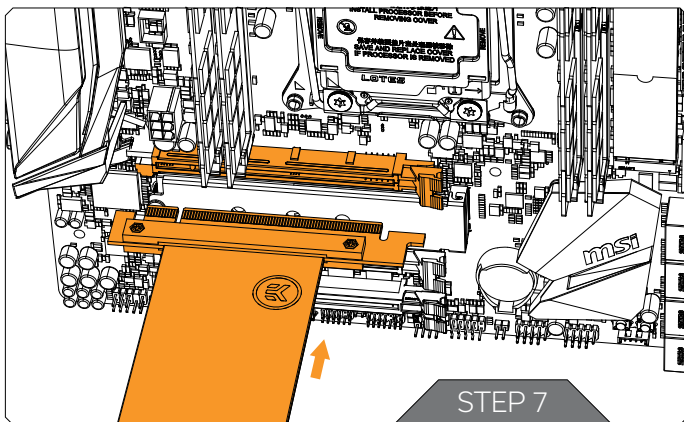

STEP 7

Carefully connect the Riser cable from the GPU Holder to the PCIE slot on the motherboard.

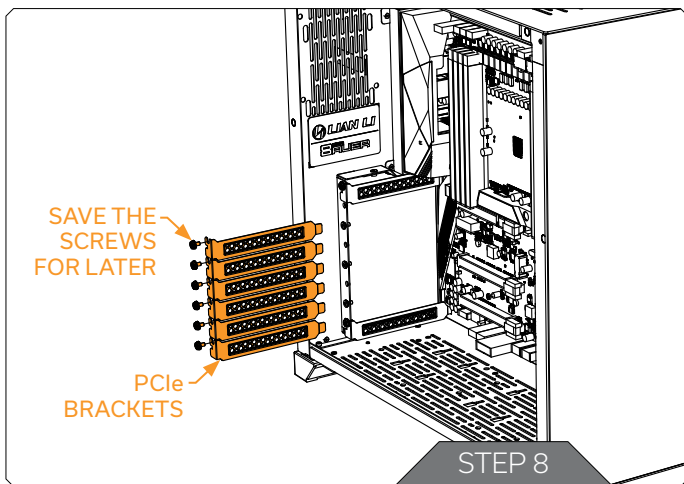

STEP 8

Remove the appropriate PCIE brackets from your case. Which brackets you need to remove depends on the installation option you chose at STEP 1.

Save all removed screws - you'll need them later.

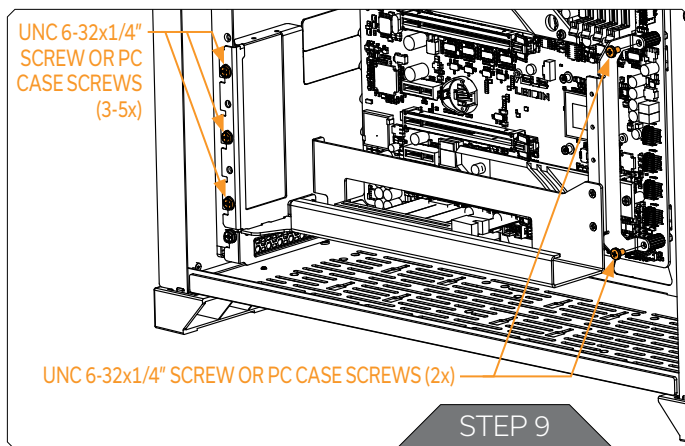

STEP 9

You may install the GPU to the GPU Holder before or after mounting the GPU Holder onto the PC case (depending of your configuration).

Use at least five screws to attach the GPU Holder to the left and right side of the PC case. Use the PCIe bracket screws that you saved earlier or UNC 6-32x1/4 screws from the package.

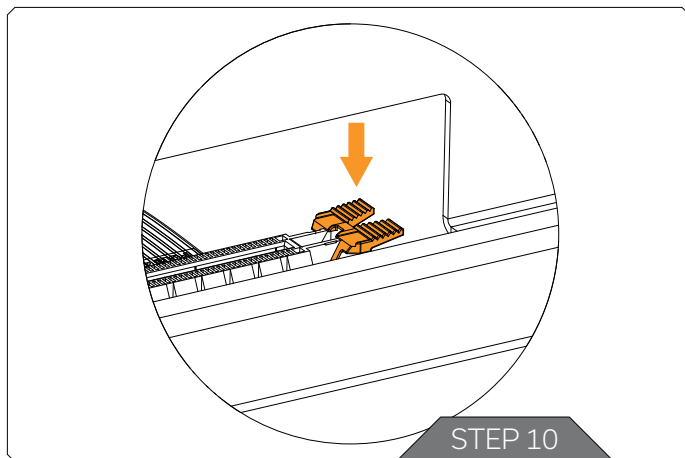

STEP 10

Before you mount the GPU, make sure the PCIe latch on the Riser cable is not closed – it must be pushed down.

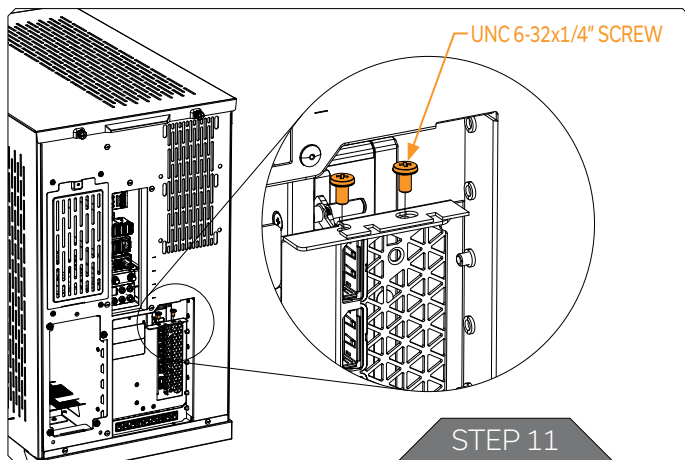

STEP 11

Carefully mount the GPU onto the GPU Holder with the two UNC 6-32x1/4 screws. Pay special attention not to damage the GPU.

STEP 12

Finally, connect the GPU cables (as instructed by the GPU manufacturer) to complete the installation.

SUPPORT AND SERVICE

In case you need assistance or wish to order spare parts or a new mounting mechanism, please contact:

<https://www.ekwb.com/customer-support/>

For spare parts orders, refer to the chapter »WHAT IS ENCLOSED« on page 4 where you can find the EAN number of each part you might need.

Include the EAN number with quantity in your request.

SOCIAL MEDIA

 EKWaterBlocks

 @EKWaterBlocks

 ekwaterblocks

 EKWBofficial

 ekwaterblocks

