



ekwb

2nd revision, Nov 10th 2016

EK-XTOP SPC/DDC

USER GUIDE

INSTALLING EK-XTOP (already done by EK)

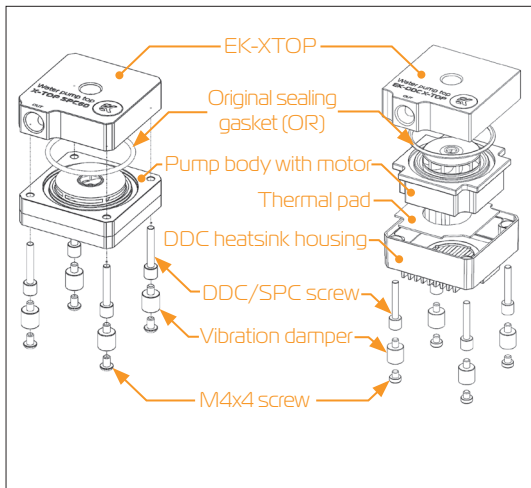

STEP 1

Install the EK-XTOP SPC/DDC on to the pump main motor housing. Make sure you re-use the original o-ring gasket! Reseat the gasket if needed. You can rotate the XTOP SPC/DDC in and use it in any direction (90° step turns).

STEP 2

Secure the XTOP SPC/DDC using enclosed SPC/DDC Screw with the 2mm Allen key. Do not over tighten the screws as excessive force may strip the threading.

INSTALLING THE ASSEMBLY

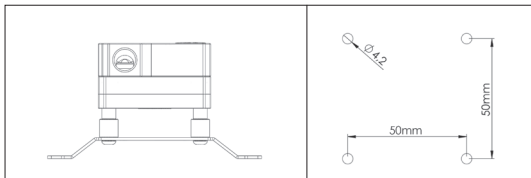

The assembly can be mounted on any flat surface inside your computer chassis.

One must drill four (4) 4.2mm holes using powerdrill in a 50x50mm square pattern. Please follow these steps:

1. Screw on Vibration Dampers on Custom SPC/DDC Screws
2. Drill four (4) 4.2mm holes into the chassis
3. Use enclosed M4×4mm screws to secure the pump to the chassis.

/ 4 /



This water pump & EK-XTOP SPC/DDC combo can be used in any mounting configuration (position) apart from being mounted upside down! Mounting the pump upside down may result in pump running dry and eventually lead to premature failure of the pump!

Any orientation of top OK!

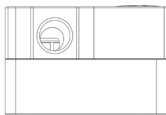

Mounted upside down. NOT OK!



ATTACHING THE FITTINGS

EK-XTOP SPC/DDC series pump tops featured 2 (two) G1/4 threaded opening on the main body of which are inlet and outlet (clearly marked with 'OUT'). EKWB recommends using EK-ACF fittings with the EK-XTOP SPC/DDC series pump tops. If you use barbed fittings, please use hose clamps or an appropriate substitute to secure tubing.

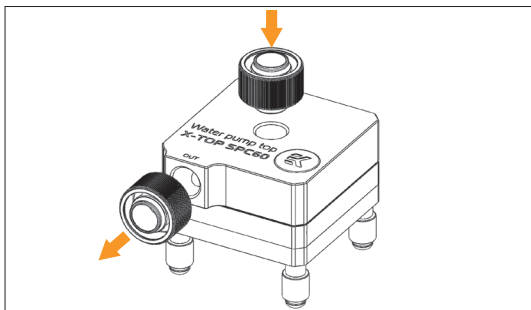

It is mandatory to use the correct INLET and OUTLET ports:

1. The OUTLET port (pressure port) is clearly marked with label 'OUT' engraved on the pump top housing.
2. The INLET port (suction port) is the central G1/4 opening on the EK-XTOP SPC/DDC front face plane. Please refer to the picture!

Use reservoir to feed the pump in order to prime it: Connect reservoir outlet port with EK-XTOP SPC/DDC inlet port!

INSTALLING THE ASSEMBLY USING EK-UNI PUMP BRACKET (optional)

If you have an option to mount the assembly on 120/140mm fan or 120/140mm fan mounting holes, EKWB recommends simple and elegant solution - EK-UNI PUMP BRACKET.

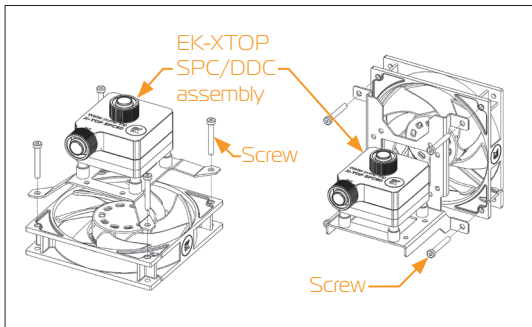

Screw for mounting the EK-UNI PUMP BRACKET on the 120/140mm FAN mounting holes:

Option 1:

use self-tapping screws normally supplied with fan to screw the holder directly on the fan

Option 2:

use 30mm long screw supplied with radiator delivery to screw the holder on the radiator through the 120/140mm fan.

Option 3:

use 5mm long screw normally supplied with radiator delivery to screw the holder directly on the radiator

Option 4:

use M4 × 6mm screw with M4 nuts and washers (supplied with the EK-UNI PUMP BRACKET) and mount the holder on the 120/140mm FAN mounting holes on the chassis.