

This product is intended for installation only by expert users. Please consult with a qualified technician for installation. Improper installation may result in damage to your equipment. EKWB d.o.o. assumes no liability whatsoever, expressed or implied, for the use of these products, nor their installation. The following instructions are subject to change without notice. Please visit our web site at [www.ekwaterblocks.com](http://www.ekwaterblocks.com) for updates. The barb hose fittings require only a small amount of force to screw them in; otherwise the high flow fittings might break. These fittings do not need to be tightened with much force because the liquid seal is made using o-rings. EKWB recommends 24 hour leak testing for all EK products before powering on the computer. This will eliminate any damages that may occur because of the users improper installation or products imperfections.

## STEP 1: GENERAL INFORMATION. Stock and possible assemblies of Multioption X2 Reservoirs

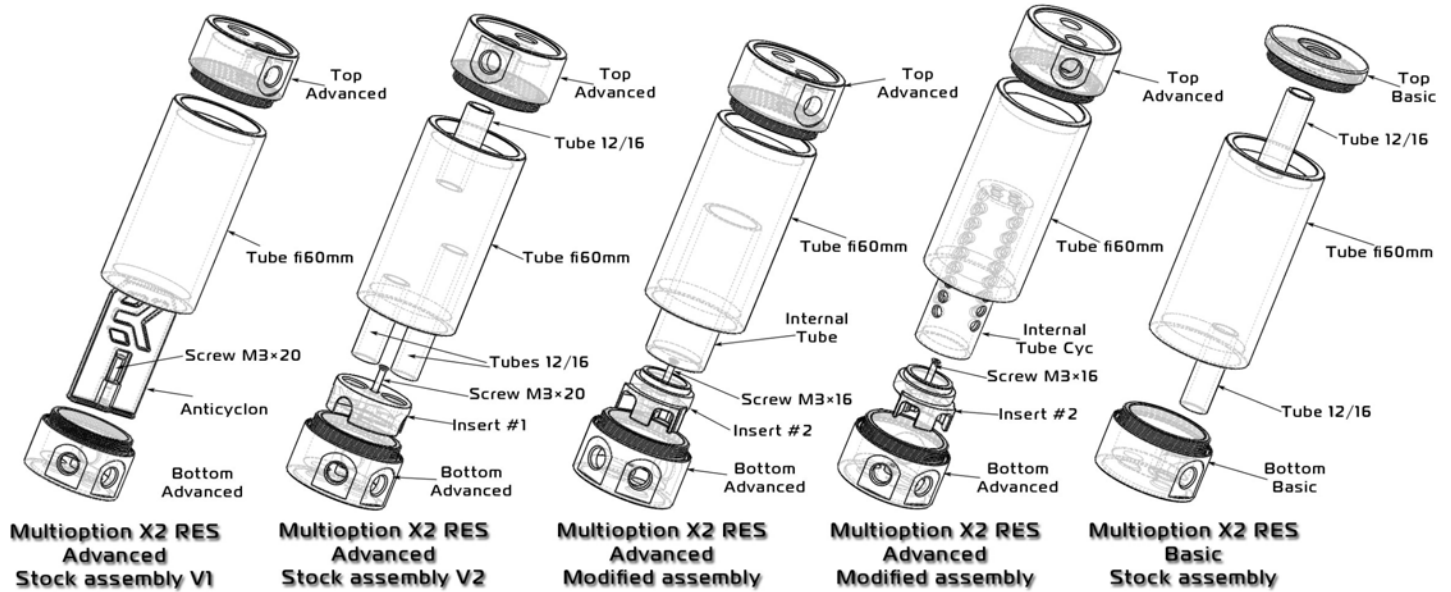

## STEP 2: MOUNTING RESERVOIR HOLDERS

EK Multioption X2 RES series reservoirs comes with a pair of special EK-Reservoir holders.

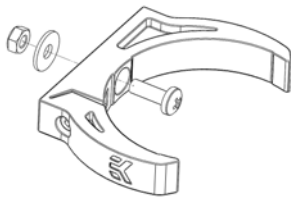

Use enclosed M4 screw, washer and nut to mount the reservoir holder.

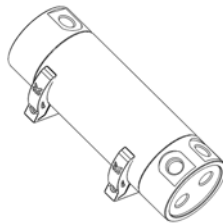

Install reservoir onto reservoir holders.

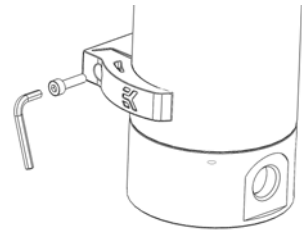

To firmly fasten the reservoir, screw in side screw of the holder. Use 2,5mm allen key. Do not use high force. Partially unscrew it when you plan to remove the reservoir.

## STEP 3a: BASIC VERSION PORTS

EK-Multioption X2 RES Basic series reservoirs have 4 available ports for fittings.

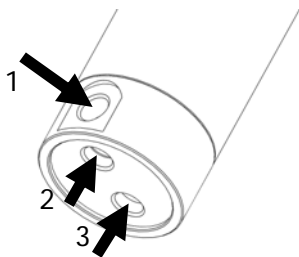

Three (3) ports in the bottom.

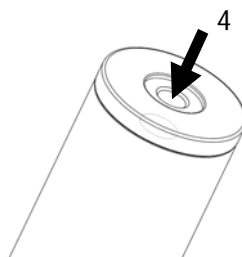

One (1) port in the top.

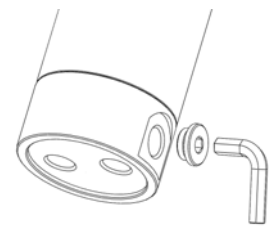

Use EK-plug and allen key to plug unused ports.

Choose ports for the fittings that suites best your watercooling system then use enclosed G1/4 plugs to plug unused ports. Use enclosed allen key to properly tighten the plugs.

## STEP 3b: ADVANCED VERSION PORTS

EK-Multioption X2 RES Advanced series reservoirs with 8 available ports for fittings have exchangeable and rotatable bottom inserts.

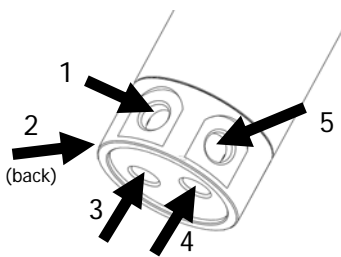

Three (5) ports in the bottom.

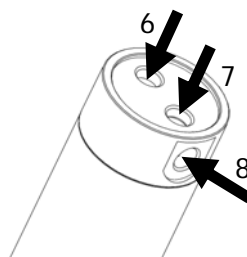

Three (3) ports in the top.

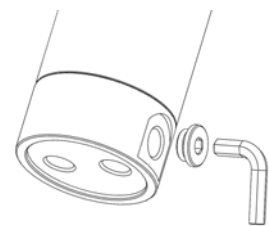

Use EK-plug and allen key to plug unused ports.

Choose ports for the fittings that suites best your watercooling system then use enclosed G1/4 plugs to plug unused ports. Use enclosed allen key to properly tighten the plugs.

# VERY IMPORTANT NOTICE:

When tightening the internal screw make sure not to overtighten it.  
Overtightening the screw will damage the thread in the reservoir bottom, rendering it useless.

## STEP 4: ADVANCED RESERVOIR INSERT OPTIONS

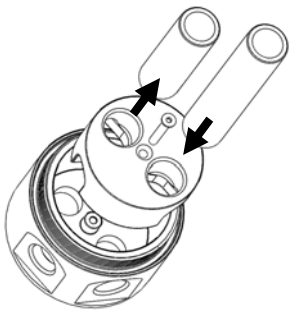

**OPTION 1: INSERT #1 at 0°**  
Inlet and outlet from the bottom side of reservoir.

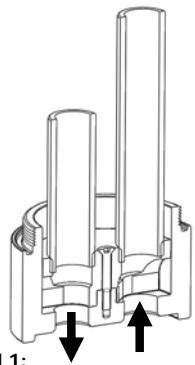

**OPTION 1:**  
Insert #1 at 90°  
Inlet and outlet from the bottom side of reservoir.

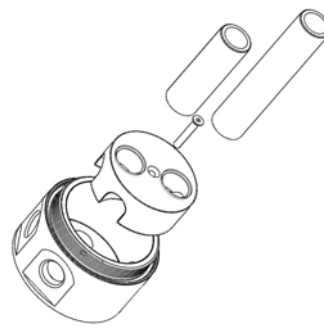

**OPTION 2: INSERT #1 at 90°**  
Three possible inlets and one possible outlet.

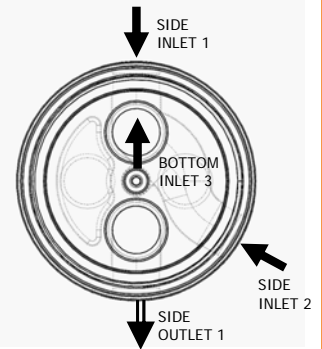

**OPTION 2: INSERT #1 at 90°**  
Inlet: 2 from the side 1 from the bottom  
Outlet: 1 from the side

## STEP 4: INSTALLING THE ANTICYCLON for ADVANCED VERSION

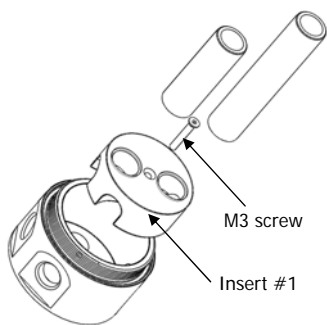

Removing stock bottom configuration:  
Unscrew reservoir tube and both small tubes. Then use 2mm allen key to unscrew the screw attaching insert #1.

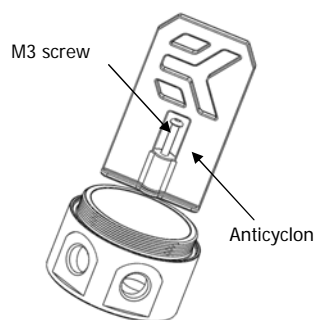

Installing Anticyclon:  
Take the Anticyclon and the M3 screw provided with anticyclone. Place screw into the hole of anticyclone.

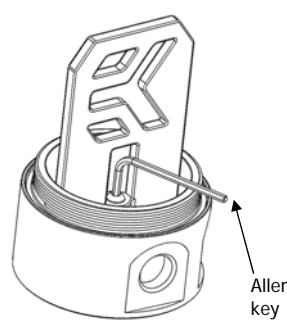

Installing Anticyclon:  
Screw in the screw with allen key. Do not use high force to tighten it, otherwise you may damage the thread.

**When tightening the internal screw make sure not to overtighten it. Overtightening the screw will damage the thread in the reservoir bottom, rendering it useless.**

## STEP 6: RESERVOIR ACCESSORIES: List of accessories for EK Multioption X2 RES

	EK-Multioption RES X2 Holder 60mm (2pcs)		EK-Multioption RES X2 BOTTOM Advanced		EK-Multioption RES X2 TOP Advanced		EK-Multioption RES X2 TOP Basic
	EK-Multioption RES X2 - INSERT #1		EK-Multioption RES X2 - INSERT #1		EK-Multioption RES X2 - Tube 16x12		EK-Multioption RES X2 - Tube 16x12 Cyclon
	EK-Multioption RES X2 - INT Tube 90mm V1		EK-Multioption RES X2 - Anticyclon		EK-Multioption RES X2 - INT Tube V1		EK-Multioption RES X2 - INT Tube V2

## STEP 7: OTHER INSTRUCTIONS

Please note that EKWB holds no responsibility of any kind if assembly is not made by instructions. This applies also for all products that are not listed as compatible on web page. Users must by all means also consider instructions that are being made for proper use of pump and other water cooling components provided by manufacturer(s).

**HINT:** Never let your pump dry running. If that happens for prolonged period of time you risk destroying bearing and rendering pump useless.