

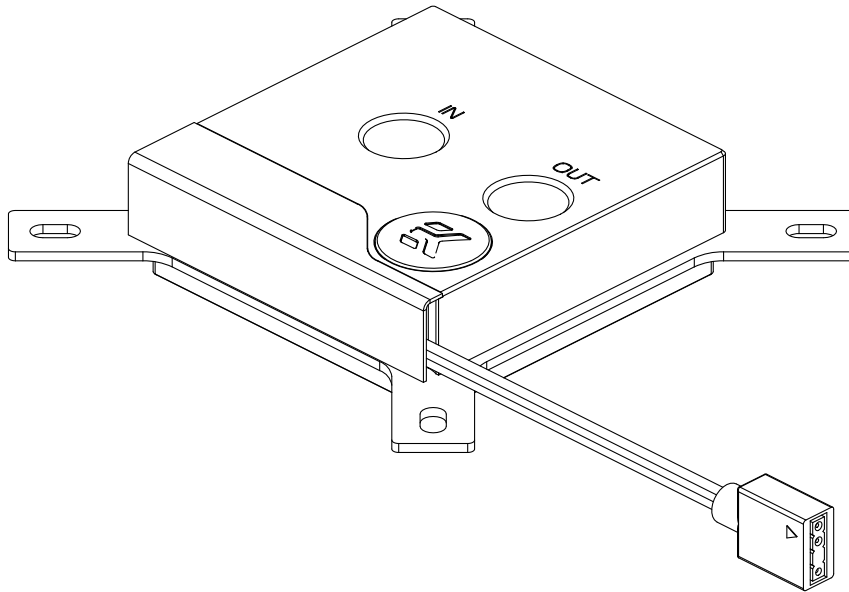

EK-Classic CPU Water Block 115x/20xx/AMD D-RGB

CPU WATER BLOCK



This product is intended for installation by expert users only. Please consult with a qualified technician for installation. Improper installation may result in damage to the equipment. EK assumes no liability whatsoever, expressed or implied, for the use of these products, nor their installation. The following instructions are subject to change without notice. Please visit our website at www.ekwb.com for updates. Before the installation of this product, please read important notice, disclosure, and warranty conditions printed on the back of the box.

Before you start using this product, please follow these basic guidelines:

Carefully read the manual before beginning with the installation process.

Remove your graphics card from the computer for the safest mounting process and to prevent any possible damages to your GPU or graphics card circuit board (PCB).

EK Fittings require only a small amount of force to screw them firmly in place since the liquid seal is ensured with the rubber O-ring gaskets.

The use of quality market-proven corrosion-inhibiting coolants is always strongly recommended for any liquid cooling system, and mandatory for nickel-plated water blocks.

Do not use pure distilled water as a cooling liquid! For best results, EK recommends the use of EK-CryoFuel Coolants.

Make sure to bleed air out of your water block thoroughly, in order to reach optimal performance.

TABLE OF CONTENT

GENERAL INFORMATION ON WATER BLOCK COMPATIBILITY	4
WHAT IS ENCLOSED	4
INSTALLING THE WATER BLOCK	5
LGA 2011(-3) SOCKET MOTHERBOARDS.....	5
LGA 115X/1200 SOCKET MOTHERBOARDS.....	7
AMD® SOCKET MOTHERBOARDS.....	11
CONNECTING THE D-RGB LED STRIP	12
SUPPORT AND SERVICE	13
SOCIAL MEDIA	13

GENERAL INFORMATION ON WATER BLOCK COMPATIBILITY

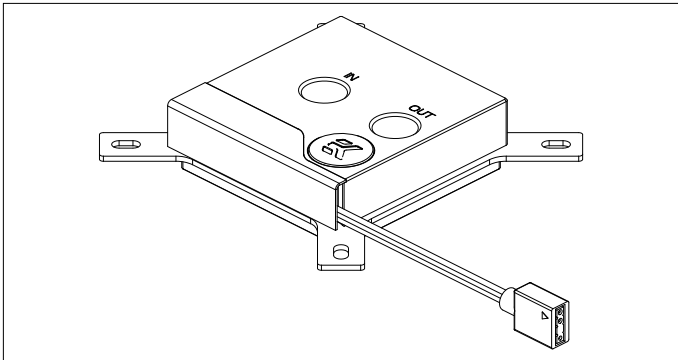

This CPU Liquid cooling units are supporting the following CPU sockets:

- **Intel® Socket LGA-115x / LGA-1200**
- **Intel® Socket LGA-20XX**
- **OPTIONAL: AMD® socket AMx and FMx**

WHAT IS ENCLOSED

- **EK-CPU Supremacy Classic D-RGB – Nickel + Plexi CPU water block.**
- **Mounting Kit Classic - Intel:**
 - Mounting Screw CPU Classic - 115X (4 pcs)
 - Mounting Screw CPU Classic - 20XX (4 pcs)
 - Mounting Spring (4 pcs)
 - Mounting Nut CPU Classic (4 pcs)
 - Washer M4x0,8mm - polyamide (4 pcs)
- **Thermal grease**
- **Metal backplate for 115x/1200**
- **Backplate rubber gasket for 115x/1200**

INSTALLING THE WATER BLOCK

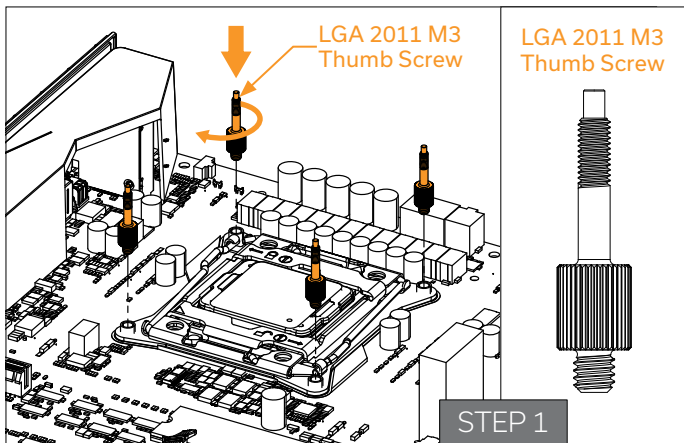

LGA 2011(-3) SOCKET MOTHERBOARDS

STEP 1

Prepare the foil bag with the mounting mechanism that is enclosed with the CPU water block.

Install four (4) specific LGA 2011 M3 thumb screws into four threaded stubs on the LGA 2011 socket's integrated latch mechanism (ILM). The screws are to be installed using no tools (i.e., pliers).



It is recommended to remove the motherboard from the chassis before proceeding with the CPU water block installation due to space constraints in various PC cases.

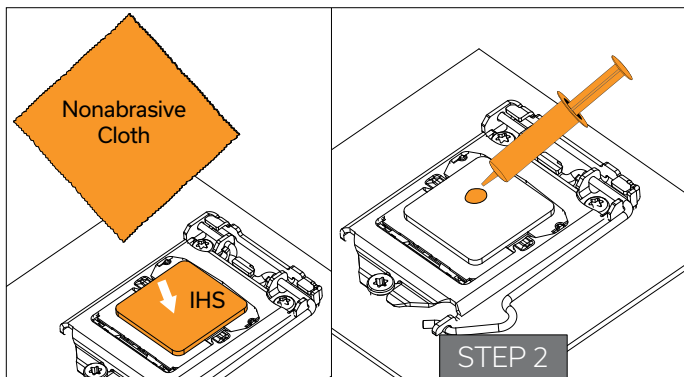

STEP 2

Cleaning the CPU: Wipe the CPU's contact surface with a nonabrasive cloth or Q-tip (as shown in the image).

Applying thermal compound: On the clean CPU IHS - Integrated Heat Spreader, apply a blob or line of enclosed thermal compound (see sample image on the left).



EK recommends the quantity of about two rice grains of thermal compound. There is no need to cover the whole IHS. Applying too much thermal grease will disrupt cooling performance!

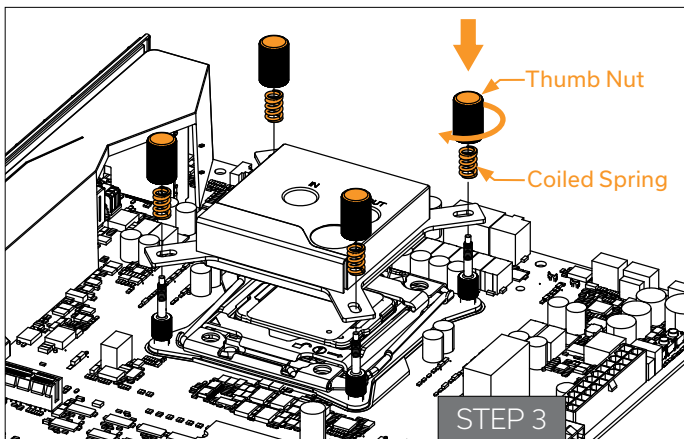

STEP 3

Remove the sticker from the water block cold plate.

Align the water block over the mounting screws on the LGA 2011(-3) motherboard with a pre-installed CPU.



Before proceeding with installation, it is mandatory to remove the protective foil from the backside of the water block.

Place an enclosed compression spring and a thumb nut over each M3 thumb screw. Start fastening two thumb nuts at a time, preferably in a cross pattern, but do not tighten them fully until all four are partially screwed in. Then - using your fingers only - screw in all four thumb nuts until you reach the end of the thread.

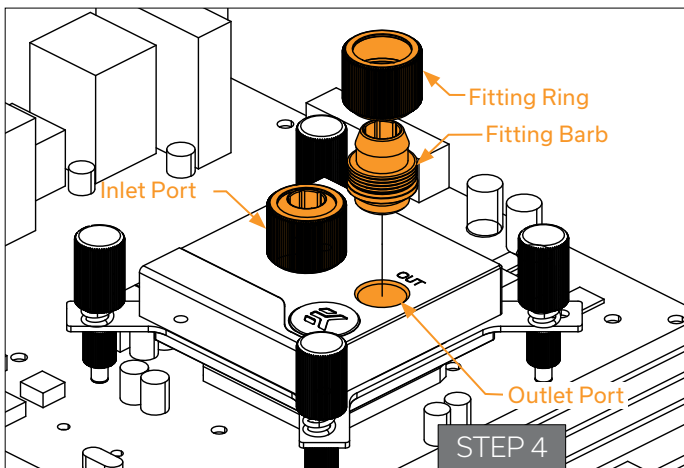

STEP 4

Tighten the fitting bars in a clockwise direction until the gasket underneath is compressed.

The installation of the CPU water block is now complete.



With EK-Supremacy Classic series water blocks, it is mandatory to use the port closest to the center of the water block as the INLET port. Mixing these ports up may result in poor thermal performance of the water block.

LGA 115X/1200 SOCKET MOTHERBOARDS

STEP 1

If already installed, please remove the motherboard from the computer case. Place it on an even surface with the front facing downward.

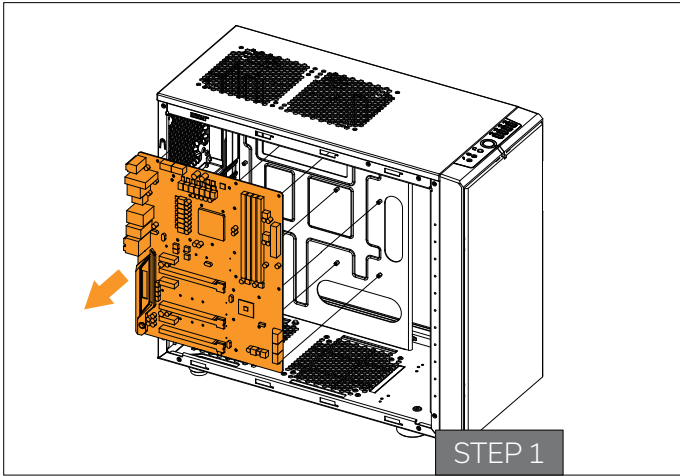

STEP 2

Preparing the Backplate Rubber Gasket

The enclosed rubber gasket is an essential part of the backplate and mounting system, and therefore must be used every time you install this water block on the motherboard.

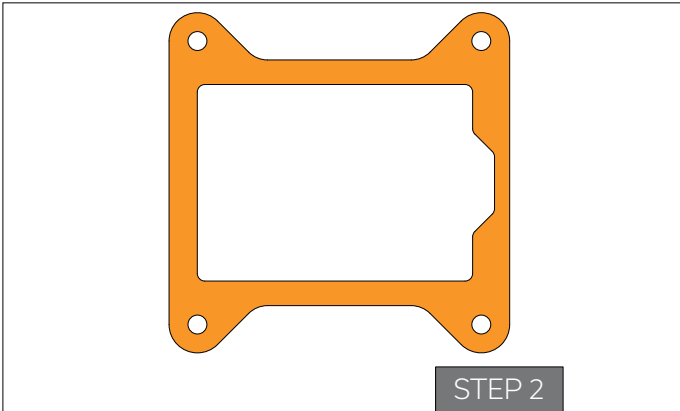

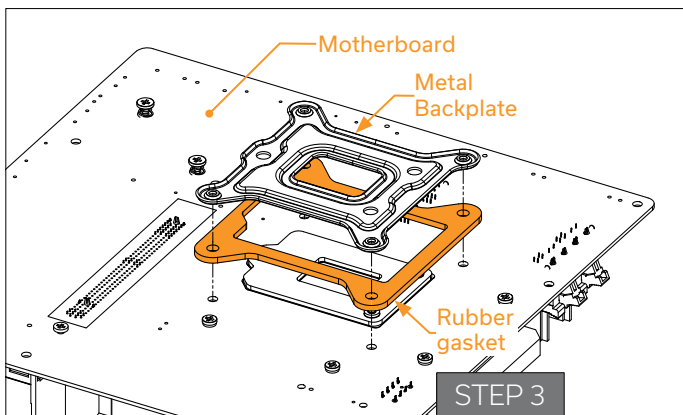

STEP 3

Install the backplate rubber gasket and place the metal backplate for Intel® LGA 115x/1200 socket to the back of your motherboard ribbed side up (facing away from the motherboard). Align the holes on the motherboard with holes on the rubber gasket and backplate.



Make sure to orientate the rubber gasket to fit past the CPU socket ILM backplate. On certain ITX form factor motherboards, the rubber gasket may need to be trimmed with household scissors.

Using one hand, carefully rotate the motherboard assembly with the front side facing up while holding the backplate and rubber gasket in place with the other hand.

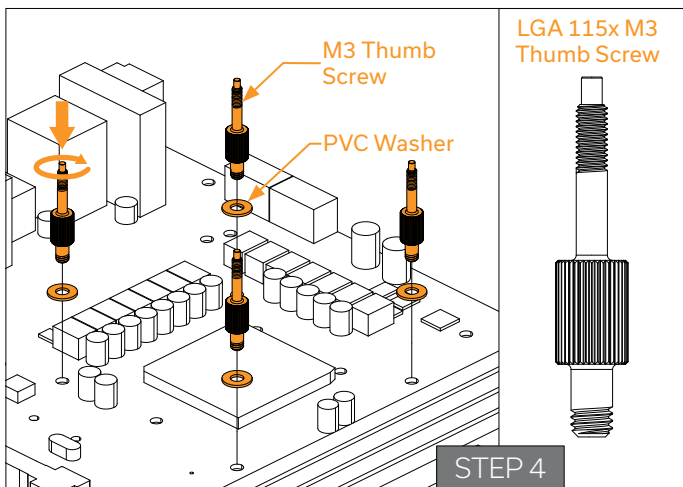

STEP 4

Install four (4) M3 thumb screws into your motherboard. It is mandatory to put a plastic washer underneath each M3 thumb screw. Tighten the screws to the metal backplate until you reach the end of the thread. Using tools (i.e., pliers) is not recommended.

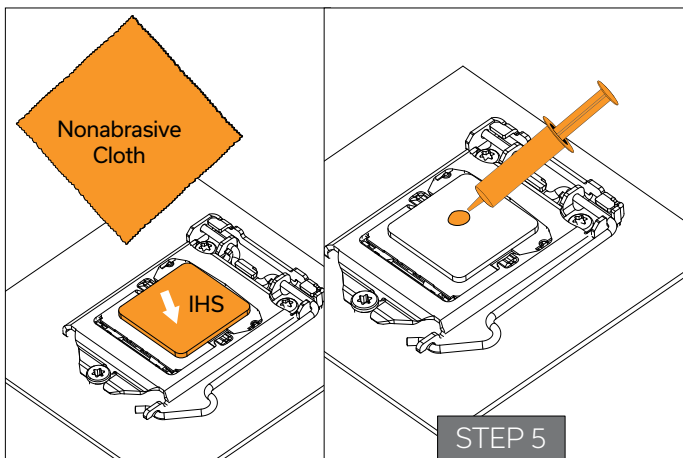

STEP 5

Cleaning the CPU: Wipe the CPU's contact surface with a nonabrasive cloth or Q-tip.

Applying Thermal Compound: On the clean CPU IHS, apply a blob or line of enclosed thermal compound (see sample image).



EK recommends the quantity of about two rice grains of thermal compound. There is no need to cover the whole IHS. Applying too much thermal grease will disrupt cooling performance!

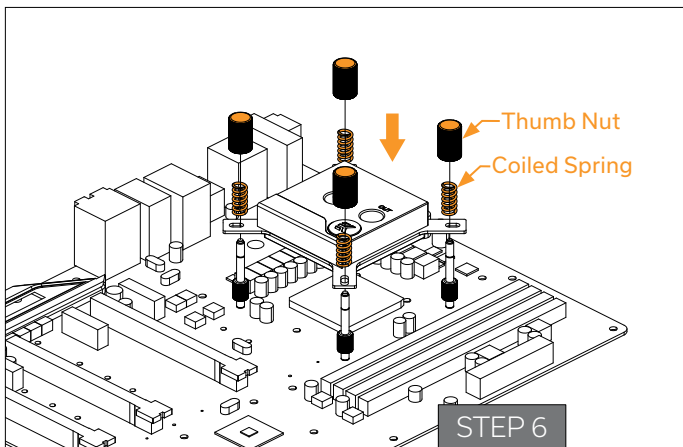

STEP 6

Align the water block over the mounting screws on the LGA 115x/1200 motherboard with a pre-installed CPU.



Before proceeding with installation, it is mandatory to remove the protective foil from the backside of the water block.

Place an enclosed coiled spring and a thumb nut over each M4 thumb screw. Start fastening two thumb nuts at a time, preferably in a cross pattern, but don't tighten them fully until all four are partially screwed in. Then - using your fingers only - screw in all four thumb nuts until you reach the end of the thread.

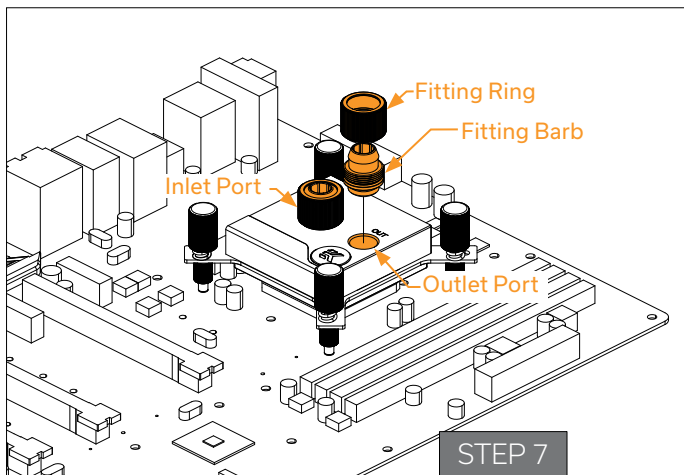

STEP 7



With EK-Supremacy Classic series water blocks, it is mandatory to use the port closest to the center of the water block as the INLET port. Mixing these ports up may result in poor thermal performance of the water block.

Tighten the fitting barb in the clockwise direction until the gasket underneath is compressed.

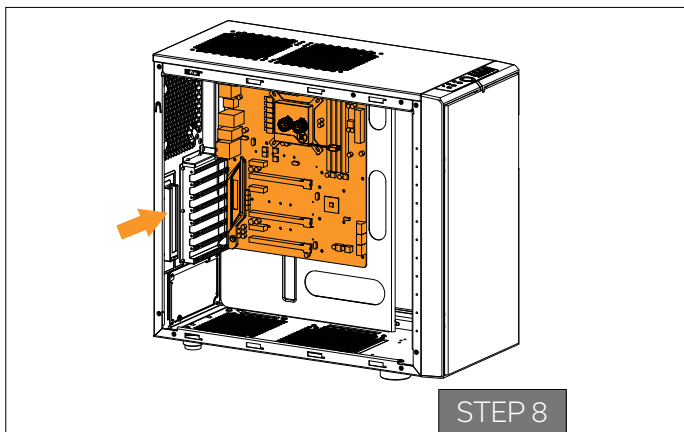

STEP 8

Install the motherboard back into the computer case.

The installation of the CPU water block is now complete.

AMD® SOCKET MOTHERBOARDS

STEP 1

Replacing the Mounting Plate

Place the water block on an even surface and, using the 2.5mm Allen key in the counter-clockwise direction, remove four M4x14 DIN 7991 screws attaching the copper base to the top.

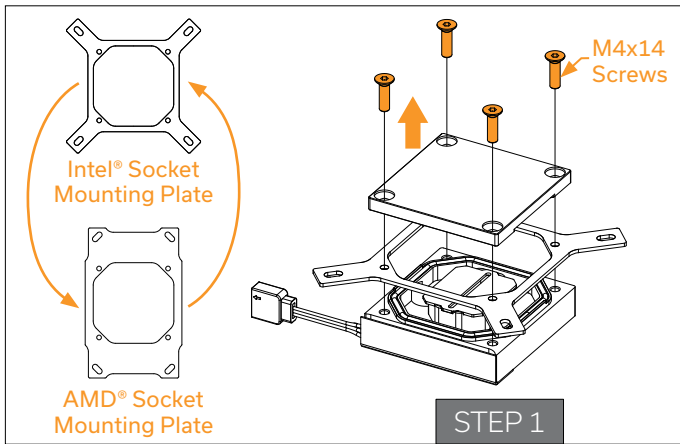

STEP 2

Replace the factory-installed Intel® mounting plate with the AMD® one. You will feel the mounting plate locking into position when placed correctly onto the top.

Reseat the O-ring gasket into the gap between the mounting plate and water block top.

 Pay special attention to the orientation of the copper base. It should be placed as shown in the picture.

Reinstall the M4x14 screws and use the 2.5mm Allen key in the clockwise direction to screw them in.

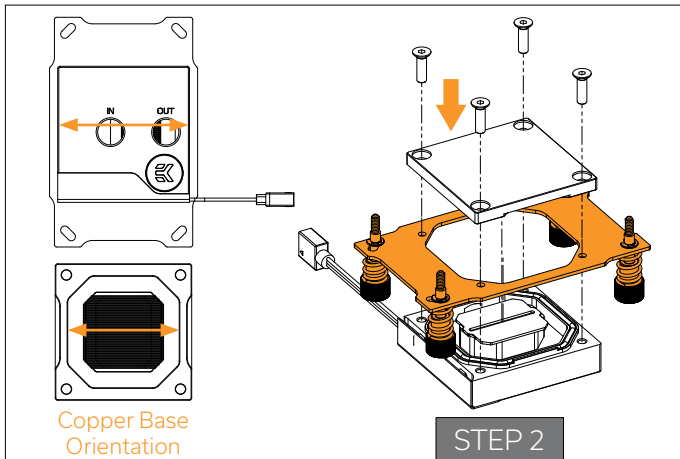

CONNECTING THE D-RGB LED STRIP

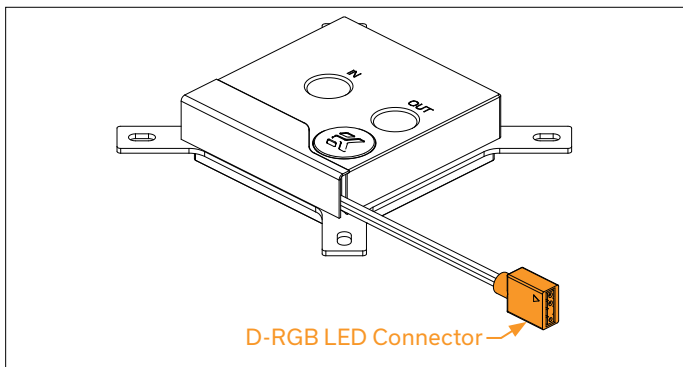

STEP 1

Connect the 3-pin D-RGB LED connector from the Water block's LED light into the D-RGB (Addressable) HEADER on the motherboard. The LEDs will work if the pin layout on the header is as follows: **+5V, Digital, Empty, Ground.**



Please ensure that the arrow indicated on the connector is plugged into the +5V line, as indicated on your motherboard. If you connect LEDs to the 12V RGB header, it will damage them.

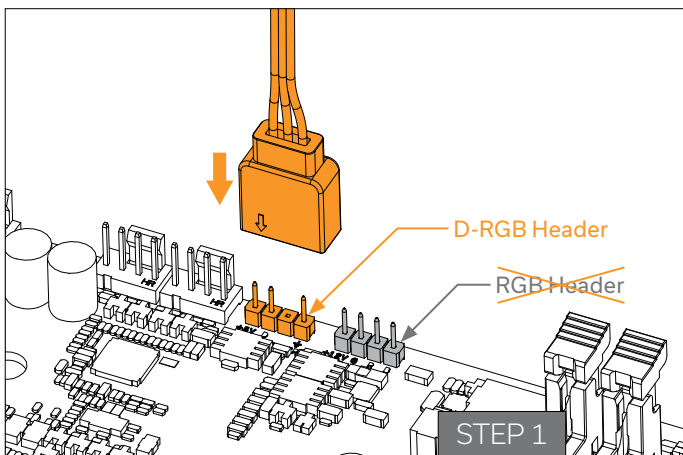

SUPPORT AND SERVICE

In case you need assistance, please contact:

<http://support.ekwb.com/>

EKWB d.o.o.
Pod lipami 18
1218 Komenda
Slovenia - EU

SOCIAL MEDIA

 EKWaterBlocks

 @EKWaterBlocks

 ekwaterblocks

 EKWBofficial

 ekwaterblocks

