

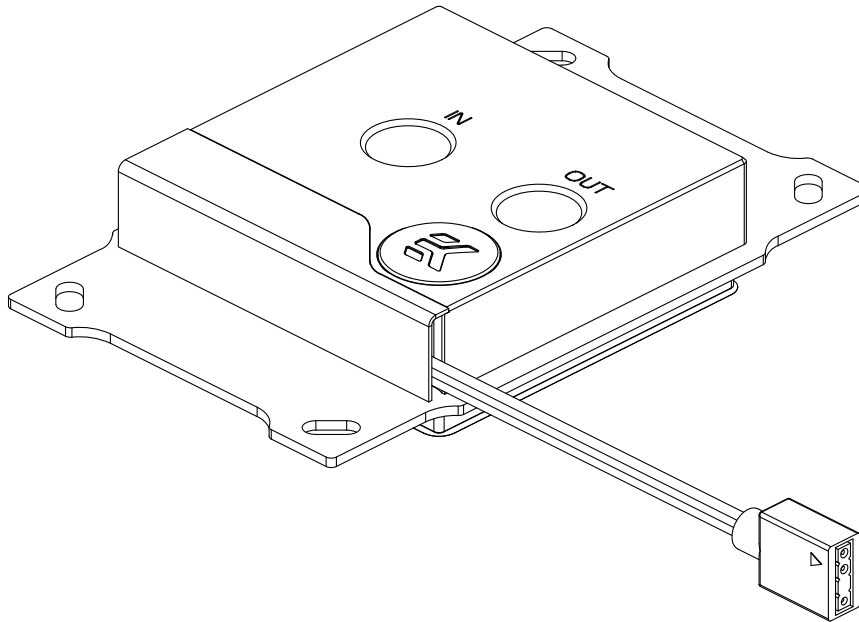

EK-Classic CPU Water Block AM4 D-RGB

CPU WATER BLOCK



This product is intended for installation by expert users only. Please consult with a qualified technician for installation. Improper installation may result in damage to the equipment. EK assumes no liability whatsoever, expressed or implied, for the use of these products, nor their installation. The following instructions are subject to change without notice. Please visit our website at www.ekwb.com for updates. Before the installation of this product, please read important notice, disclosure, and warranty conditions printed on the back of the box.

Before you start using this product, please follow these basic guidelines:

Carefully read the manual before beginning with the installation process.

Remove your graphics card from the computer for the safest mounting process and to prevent any possible damages to your GPU or graphics card circuit board (PCB).

EK Fittings require only a small amount of force to screw them firmly in place since the liquid seal is ensured with the rubber O-ring gaskets.

The use of quality market-proven corrosion-inhibiting coolants is always strongly recommended for any liquid cooling system, and mandatory for nickel-plated water blocks.

Do not use pure distilled water as a cooling liquid! For best results, EK recommends the use of EK-CryoFuel Coolants.

Make sure to bleed air out of your water block thoroughly, in order to reach optimal performance.

TABLE OF CONTENT

GENERAL INFORMATION ON WATER BLOCK COMPATIBILITY	4
WHAT IS ENCLOSED	4
INSTALLING THE WATER BLOCK	5
AMX AND FMX SOCKET MOTHERBOARDS	5
CONNECTING THE D-RGB LED STRIP	8
SUPPORT AND SERVICE	9
SOCIAL MEDIA	9

GENERAL INFORMATION ON WATER BLOCK COMPATIBILITY

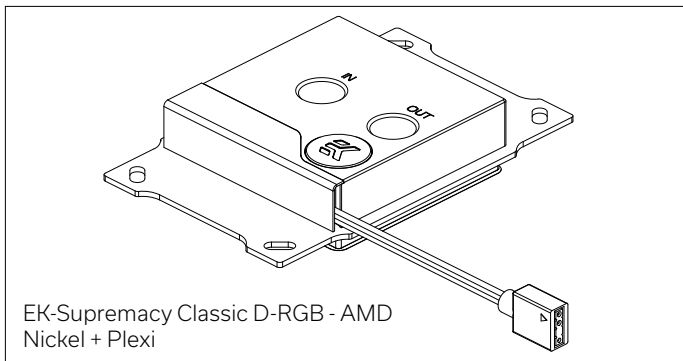

This CPU Liquid cooling unit is supporting the following CPU sockets:

- **AMD® AMx**
- **AMD® FMx**

WHAT IS ENCLOSED

- **EK-Supremacy Classic D-RGB - AMD Nickel + Plexi water block.**
- **Mounting Kit Classic – AMD:**
 - Mounting Screw CPU Classic- AM4 (4 pcs)
 - AM4 Standoff (4 pcs)
 - Mounting Spring (4 pcs)
 - Thumb nut (4 pcs)
- **Thermal grease**

INSTALLING THE WATER BLOCK

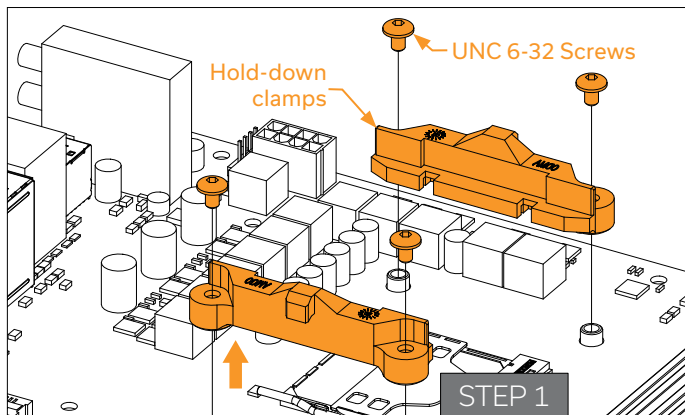

AMx AND FMx SOCKET MOTHERBOARDS

STEP 1

Removing the Original Hold-Down Clamps

Using a Philips head screwdriver, remove the four UNC 6-32 screws securing the original plastic hold-down clamps around the socket (as shown in the picture). **Keep the original AMD® backplate and remove the hold-down clamps to store them away.**

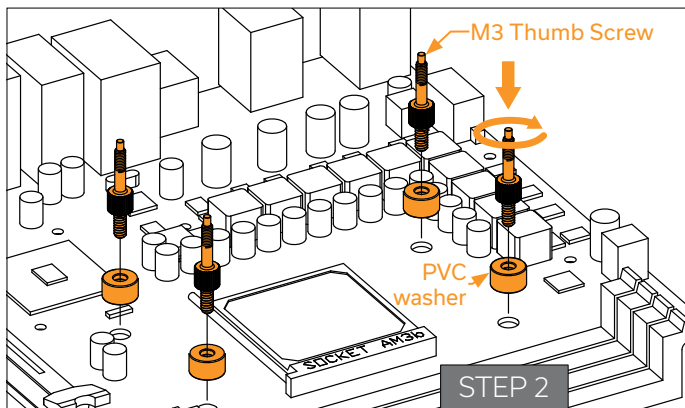

STEP 2

Prepare the foil bag with the mounting mechanism that is enclosed with the CPU water block.

Install four (4) M3 thumb screws into your motherboard. It is mandatory to put a plastic AM4 standoff underneath each M3 thumb screw. The screws are to be installed using no tools (i.e., pliers).

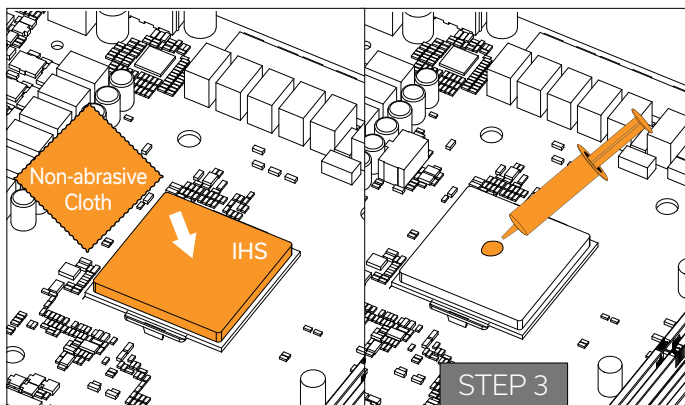

STEP 3

Cleaning the CPU: Wipe the CPU's contact surface (by using non-abrasive cloth or Q-tip, as shown on sample photo).

Applying thermal compound: EK recommends blob or line method of applying the enclosed thermal compound to the CPU heat spreader (IHS) - see sample photo on right.



The quantity of about two rice grains is just about right.
There is no need to cover the whole IHS. Applying too much thermal grease will have negative impact on the cooling performance!

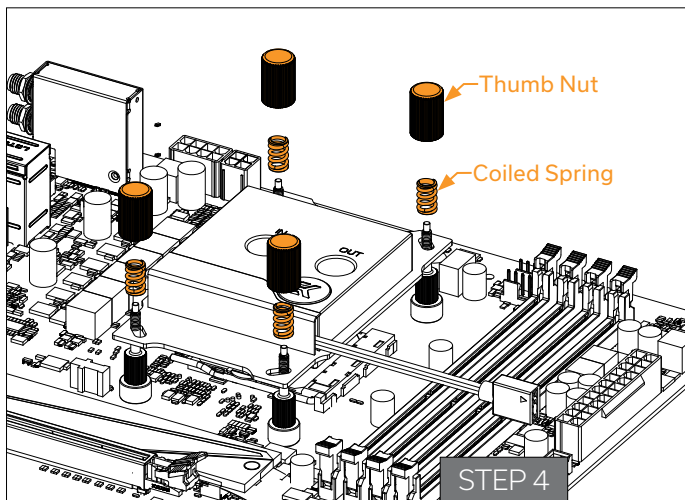

STEP 4

Align the water block over the mounting screws on the motherboard with a pre-installed CPU.

Before proceeding with the installation it is mandatory to remove the protective foil from the backside of the water block.

Place an enclosed compression spring and thumb nut over each M3 thumb screw. Start fastening two thumb nuts at a time, preferably in cross pattern and do not tighten them fully until all four are partially screwed in. Then - using your fingers only - screw in all four thumb nuts until you reach the end of the thread.

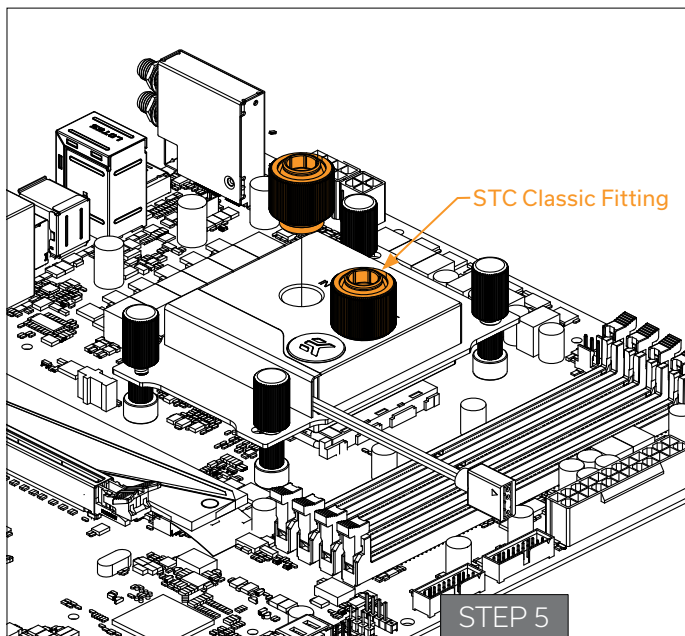

STEP 5 INSTALLING THE FITTINGS

Tighten the fitting barbs in clockwise direction until the gasket underneath is compressed.

The installation of the CPU water block is now complete.



With EK-Supremacy Classic series water blocks, it is mandatory to use the port closest to the center of the water block as the INLET port. Mixing these ports up may result in poor thermal performance of the water block.

CONNECTING THE D-RGB LED STRIP

STEP 1

Connect the 3-pin D-RGB LED connector from the Water block's LED light into the D-RGB (Addressable) HEADER on the motherboard. The LEDs will work if the pin layout on the header is as follows: **+5V, Digital, Empty, Ground.**



Please ensure that the arrow indicated on the connector is plugged into the +5V line, as indicated on your motherboard. If you connect LEDs to the 12V RGB header, it will damage them.

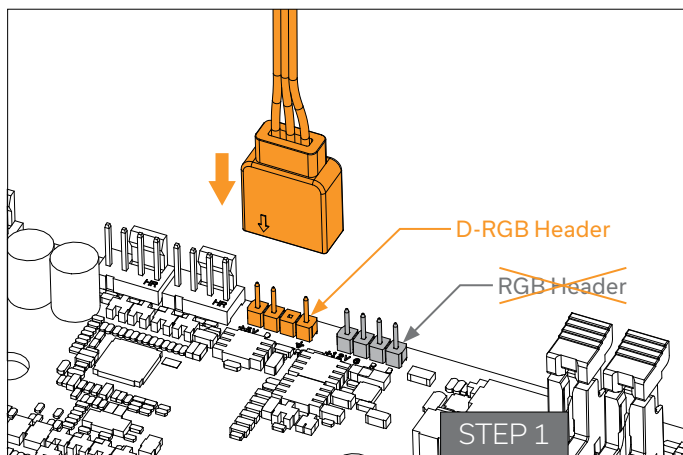
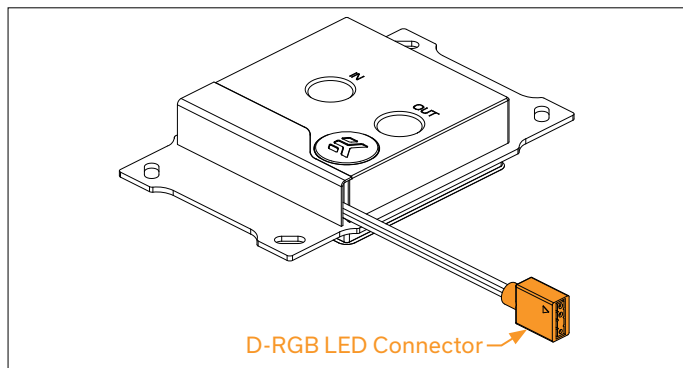

SUPPORT AND SERVICE

For assistance please contact:

<http://support.ekwb.com/>

EKWB d.o.o.
Pod lipami 18
1218 Komenda
Slovenia - EU

SOCIAL MEDIA

 EKWaterBlocks

 @EKWaterBlocks

 ekwaterblocks

 EKWBofficial

 ekwaterblocks

