

This product is intended for installation only by expert users. Please consult with a qualified technician for installation. Improper installation may result in damage to your equipment. EK Water Blocks assumes no liability whatsoever, expressed or implied, for the use of these products, nor their installation. The following instructions are subject to change without notice. Please visit our web site at [www.ekwaterblocks.com](http://www.ekwaterblocks.com) for updates. Before installation of this product please read any important notice, disclosure and warranty conditions printed on the back of the box and on EKWB home page.

**EKWB recommends using EK-PSC fittings which require a small amount of force to screw them in; otherwise fittings might break or damage your block. These fittings do not need to be tightened with much force because the liquid seal is made using o-rings. Use of corrosive inhibitors is highly recommended.**

**STEP 1: GENERAL INFORMATION.** Sample picture of ASUS P8P67 motherboard.



**STEP 2: PREPARING YOUR MOTHERBOARD**

1. REMOVING STOCK COOLER. Remove all encircled screws pins. Both mosfet heat sinks should be removed. There are 4 plastic retention pins on the back of the motherboard.

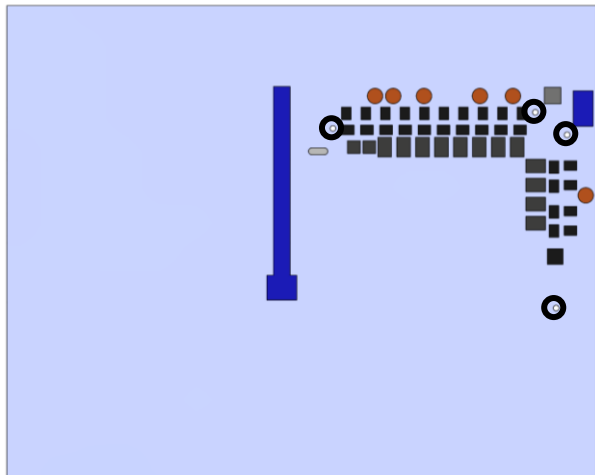

2. CUTTING THERMAL PADS. Your block comes with two precut thermal pads, which have to be placed on mosfet chips. (PLEASE REMOVE FOIL OF THERMAL PADS PRIOR TO INSTALLATION.)

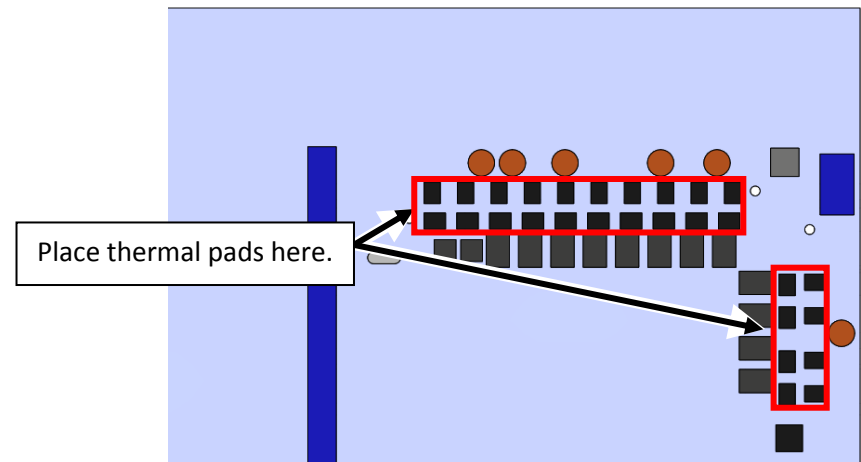

**STEP 3: PREPARING YOUR WATERBLOCK**

1. PLACING STANDOFFS ON WATERBLOCK. Your waterblock comes with 4 standoffs (height 2,1 mm) that prevent overtightening of screws. Nonetheless avoid using excessive mounting force. To ensure standoffs stay in place you are encouraged to use small amount of thermal grease on standoffs, thus making them adhesive.

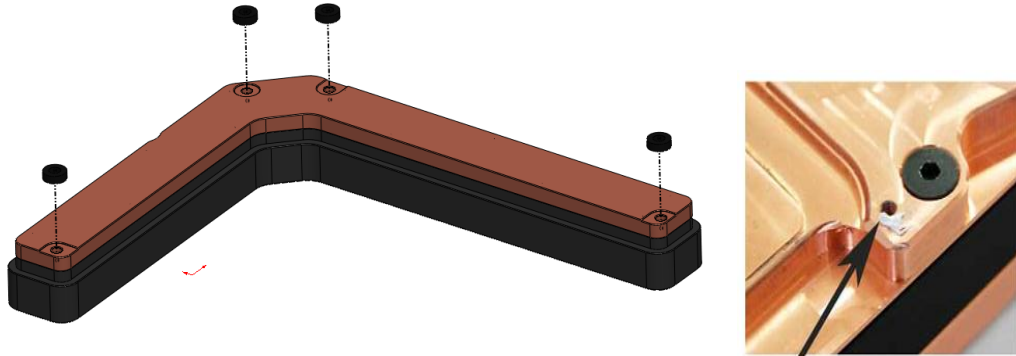

2. PLACING WATERBLOCK ON MOTHERBOARD. Place waterblock on mosfet section as shown on picture.

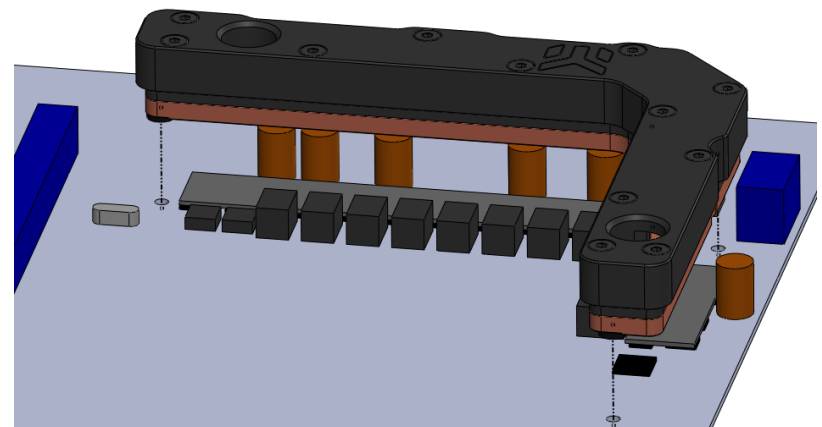

3. ATTACHING WATERBLOCK ON MOTHERBOARD. When waterblock is safely placed on motherboard, please align holes and fasten enclosed M3x6 screws to waterblock. It is recommended that you check for unwanted contacts before powering up system.

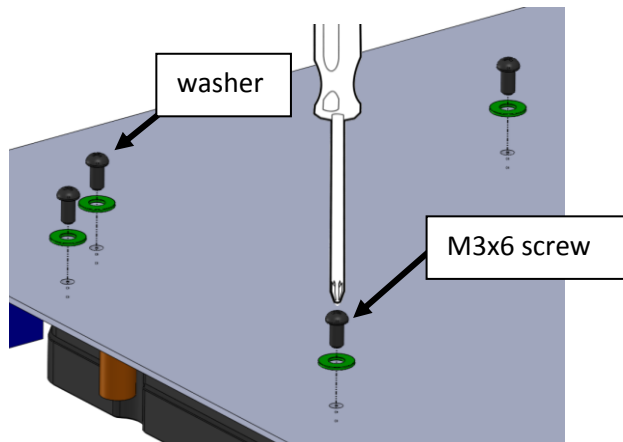

4. POSITIONING FITTINGS AND CONNECTING TO WATER CIRCUIT. Attach the liquid cooling tubes and connect the water-block(s) into the cooling circuit. To ensure that the tubes are securely attached to the barb/fittings, please use hose clamps or an appropriate substitute. The use of an algacide and corrosion inhibitors is always recommended for any liquid cooling system. You can use any opening as an inlet/outlet port.

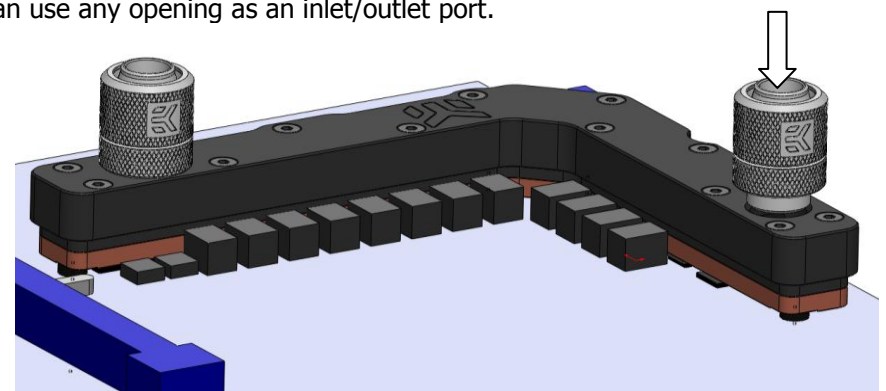

**REQUIRED TOOLS AND MOUNTING SCREWS:**

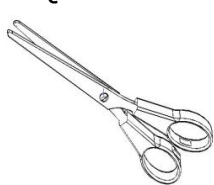

scissors



philips screwdriver

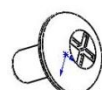

4 screws M3x6 DIN9785



4 PVC washers